

**NOTICE!!**

**These documents have been scanned!**

**Do not place un-scanned documents beneath this notice!**

**Do not remove this notice from this file!**

GPO Jacket No. 560-102  
Print Order 61540  
Rise Business Services, LLC  
Job=AZ15 5/15/2019



Box Number= AZ15053



Claim Begin-End: AMC412575-AMC412576

1 Initial Receipt



AZ15053-2

AMC412566-AMC413285

United States Department of the Interior  
Bureau of Land Management  
LANDS/RECREATION & PLANNING  
ONE N CENTRAL AVE  
PHOENIX, AZ 85004 -2203  
Phone: 602-417-9200

Receipt

No: 2482830

<b>Transaction #:</b> 2559474 <b>Date of Transaction:</b> 12/15/2011	<b>ENTERED INTO COMPUTER</b>
<b>CUSTOMER:</b> DEC 29 2011 <i>JB</i>	
PRESTON PIEPER 200 HIGH CHAPARRAL PRESCOTT, AZ 86303-6356 US	

LINE #	QTY	DESCRIPTION	REMARKS	UNIT PRICE	TOTAL
1	2.00	LOCATABLE MINERALS / MINING CLAIMS- NEW, UNADJUD, ONE OR MORE AUTH NOS / NEW MINING CLAIM PROCESSING FEE \$15 <b>CASES:</b> AMC412575/\$15.00, AMC412576/\$15.00		- n/a -	30.00
2	2.00	LOCATABLE MINERALS / MINING CLAIMS- NEW, UNADJUD, ONE OR MORE AUTH NOS / NEW MINING CLAIM LOCATION FEE \$34 <b>CASES:</b> AMC412575/\$34.00, AMC412576/\$34.00		- n/a -	68.00
3	2.00	LOCATABLE MINERALS / MINING CLAIMS- NEW, UNADJUD, ONE OR MORE AUTH NOS / NEW MINING CLAIM MAINT FEE \$140 <b>CASES:</b> AMC412575/\$140.00, AMC412576/\$140.00		- n/a -	280.00
<b>TOTAL:</b>					<b>\$378.00</b>

PAYMENT INFORMATION			
1	AMOUNT:	378.00	POSTMARKED: 12/13/2011
	TYPE:	CHECK	RECEIVED: 12/15/2011
	CHECK NO:	2378	
	NAME:	PIEPER, PRESTON L 200 HIGH CHAPARRAL PRESCOTT AZ 86303-6356 US	

REMARKS

This receipt was generated by the automated BLM Collections and Billing System and is a paper representation of a portion of the official electronic record contained therein.

**NOTICE!!**

**These documents have been scanned!**

**Do not place un-scanned documents beneath this notice!**

**Do not remove this notice from this file!**

GPO Jacket No. 560-102  
Print Order 61540  
Rise Business Services, LLC  
Job=AZ15 5/15/2019



Box Number= AZ15053



Claim Begin-End: AMC412575-AMC412576

2 Correspondence



AZ15053-2

AMC412566-AMC413285

**NO  
DOCUMENTS  
FOUND**

NO DOCUMENTS FOUND  
NO DOCUMENTS FOUND



**NOTICE!!**

**These documents have been scanned!**

**Do not place un-scanned documents beneath this notice!**

**Do not remove this notice from this file!**

GPO Jacket No. 560-102  
Print Order 61540  
Rise Business Services, LLC  
Job=AZ15 5/15/2019



Box Number= AZ15053



Claim Begin-End: AMC412575-AMC412576

3 Transfers



AZ15053-2

AMC412566-AMC413285

**NO  
DOCUMENTS  
FOUND**

NO DOCUMENTS FOUND  
NO DOCUMENTS FOUND

**NOTICE!!**

**These documents have been scanned!**

**Do not place un-scanned documents beneath this notice!**

**Do not remove this notice from this file!**

GPO Jacket No. 560-102  
Print Order 61540  
Rise Business Services, LLC  
Job=AZ15 5/15/2019



Box Number= AZ15053



Claim Begin-End: AMC412575-AMC412576

4 Miscellaneous



AZ15053-2

AMC412566-AMC413285

**NO  
DOCUMENTS  
FOUND**

NO DOCUMENTS FOUND  
NO DOCUMENTS FOUND

**NOTICE!!**

**These documents have been scanned!**

**Do not place un-scanned documents beneath this notice!**

**Do not remove this notice from this file!**

GPO Jacket No. 560-102  
Print Order 61540  
Rise Business Services, LLC  
Job=AZ15 5/15/2019



Box Number= AZ15053



Claim Begin-End: AMC412575-AMC412576

5 Annual Filings



AZ15053-2

AMC412566-AMC413285



UNITED STATES  
DEPARTMENT OF THE INTERIOR  
BUREAU OF LAND MANAGEMENT

**MAINTENANCE FEE WAIVER CERTIFICATION**

SEE INSTRUCTIONS ON PAGE 2

241  
JME

417461  
412575

FORM APPROVED  
OMB NO. 1004-0114  
Expires: 381462

1. This small miner waiver is filed for the assessment year beginning on September 1, 2018 and ending on September 1, 2019.
2. The undersigned and all related parties owned ten or fewer mining claims, mill, or tunnel sites located and maintained on Federal lands in the United States of America on September 1, 2019.
3. The undersigned have performed the assessment work required by law for each mining claim listed prior to filing this waiver and understand that by filing this form the undersigned must file an affidavit of assessment work with the Bureau of Land Management (BLM) by the December 30th following the filing of this waiver.
4. The undersigned understand that if the assessment work obligation has not yet come due under 30 U.S.C. 28 (for those claims in their first assessment year only), a notice of intent to hold reciting this condition must be recorded by the December 30th following the filing of this waiver.
5. The undersigned understand that mill and tunnel sites may also be listed on this waiver and be waived from payment of the maintenance fee, and that a notice of intent to hold for these sites is required to be filed with the BLM by the December 30th following the filing of this waiver.
6. The undersigned understand and acknowledge that pursuant to 43 U.S.C. 1212 and 18 U.S.C. 1001, the filing or recording of a false, fictitious, or fraudulent document with the BLM may result in a fine of up to \$250,000, a prison term not to exceed five years, or both.
7. The mining claims, mill or tunnel sites for which this waiver from payment of the maintenance fees is requested are:

CLAIM OR SITE NAME	BLM RECORDATION SERIAL NUMBER
1. <u>MPCD3</u>	<u>Amc 417461</u>
2. <u>MPCD2</u>	<u>Amc 412576</u>
3. <u>MPCD1</u>	<u>Amc 412575</u>
4. <u>Big BEND</u>	<u>Amc 381462</u>
5.	
6.	
7.	
8.	
9.	
10.	

RECEIVED  
BLM AZ STATE OFFICE  
2019 AUG 13 A 8:05  
PHOENIX, ARIZONA

The owner(s) (claimants) of the above mining claims and sites are:

PRESTON PIEPER ✓  
(Owner's Name - Please Print)  
200 High CHAPARRAL  
(Owner's Mailing Address)

Preseott ✓  
(Owner's Signature)  
Preseott AZ 86303  
(City) (State) (Zip Code)

MARILYN PIEPER ✓  
(Owner's Name - Please Print)  
200 High CHAPARRAL  
(Owner's Mailing Address)

Marilyn Pieper ✓  
(Owner's Signature)  
PRESEOTT AZ 86303  
(City) (State) (Zip Code)

AC483  
ENTERED SEP 13 2019  
PB

\_\_\_\_\_  
(Owner's Name - Please Print)  
\_\_\_\_\_  
(Owner's Mailing Address)  
\_\_\_\_\_  
(Owner's Name - Please Print)  
\_\_\_\_\_  
(Owner's Mailing Address)

\_\_\_\_\_  
(Owner's Signature)  
\_\_\_\_\_  
(City) (State) (Zip Code)  
\_\_\_\_\_  
(Owner's Signature)  
\_\_\_\_\_  
(City) (State) (Zip Code)

# 4532200



When Recorded Return Document :

PRESTON PIEPER  
200 HIGH CHAPARRAL  
PRESCOTT, AZ 86303

2018-0038960  
07/30/2018 09:15:31 AM DL Page: 1 of 2  
Leslie M. Hoffman  
OFFICIAL RECORDS OF YAVAPAI COUNTY \$15.00  
PRESTON PIEPER



☐ Check here if this is a change of address.

Telephone: \_\_\_\_\_

E-mail address: \_\_\_\_\_

Amc 412575

417461

381462

### AFFIDAVIT OF PERFORMANCE OF ANNUAL WORK

1. State of Arizona, County of YAVAPAI SS: \_\_\_\_\_

2. I (Name) PRESTON PIEPER

3. Reside at (Address) 200 HIGH CHAPARRAL

City PRESCOTT County YAVAPAI

State AZ Zip 86303 being duly sworn, depose and say that I am a citizen of the United States, more than eighteen years of age, and that all of the facts set forth in this affidavit, subject to the provisions and penalties of 18 U.S.C. 1001 pertaining to the filing of false, fictitious, or fraudulent statements with the United States, are true and correct according to the best of my knowledge, information and belief.

4. Owner's name and address (If not shown in Items 1-3 above). MARILYN PIEPER  
200 HIGH CHAPARRAL PRESCOTT, AZ 86303

5. That I am personally acquainted with the mining claim(s). The work and improvements were made by and at the expense of the owner(s) of said claim(s). Said contiguous group of claims, listed on this document, are situated in the

(optional) Mining District; YAVAPAI County, Arizona.

Line No.	AMC NUMBER	CLAIM/SITE NAME	COUNTY RECORDER DATA (If available)	TWP	RNG	SEC
1	412575	MPCD 1	4843 857	10N	2E	31
2	412576	MPCD 2	4843 856	10N	2E	32
3	417461	MPCD 3	4903 346	10N	2E	31
4	381462	Big Bend	4492 514	10N	2E	32
5						
6						

AC 480  
ENTERED AUG 30 2018  
PB

Form: MCF108  
Revised July 2014  
Page 1 of 2

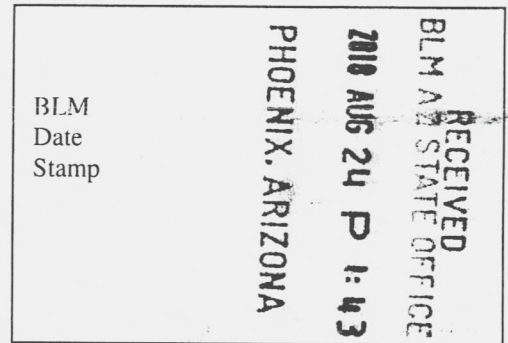

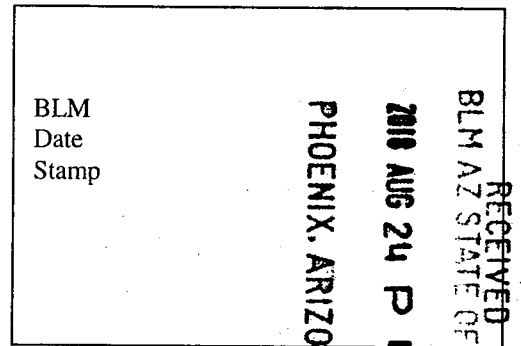

7						
8						
9						
10						

6. That between the dates starting at 12 o'clock noon on September 1, 20 17 and ending at 12 o'clock noon on September 1, 20 18 at least \$ 500.00 dollars worth of work and improvements were done and performed upon said claim(s) or upon one or more of a contiguous group of claims for the benefit of all, wholly or partly outside of a contiguous group of claims for the benefit of all, not including the location work.

7. That the following persons were employed to perform the work and improvements described herein: \_\_\_\_\_

\* PRESTON Pieper, SHAWN ANTHONY, DAVID RIDENHOOR

8. That the work and improvements performed were: ROAD REPAIRS, ACTIVE MINING, SAMPLING

\* PRESTON PIEPER, SHAWN ANTHONY, DAVID RICHTEH HOOR

9. Dated: 7-30-18 Signature: \_\_\_\_\_

SUBSCRIBED AND SWORN TO before me, a Notary Public, this 30<sup>th</sup> day of July 20 18

By: Preston Pieper

Notary Public

Colleen Lay

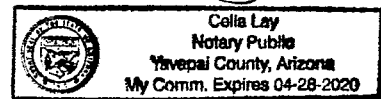

My Commission Expires 04-28-2020

Bureau of Land Management  
Arizona State Office  
[www.blm.gov/az](http://www.blm.gov/az)

No. of Claims: \_\_\_\_\_ x \$10 = \_\_\_\_\_  
Check No.: \_\_\_\_\_ Init. \_\_\_\_\_  
Receipt No.: 4245903  
For BLM Use Only



PRESTON L PIEPER  
200 HIGH CHAPARRAL  
PRESCOTT AZ 86303-6356

PHOENIX AZ 852

23 AUG 2018 PM 8 L



BUREAU OF LAND MANAGEMENT  
ARIZONA STATE OFFICE  
1 NORTH CENTRAL AVENUE, SUITE 8  
PHOENIX, ARIZONA 85004

PHOENIX, ARIZONA

2018 AUG 24 P 1:43

RECEIVED  
BLM AZ STATE OFFICE

85004\$4427 C041

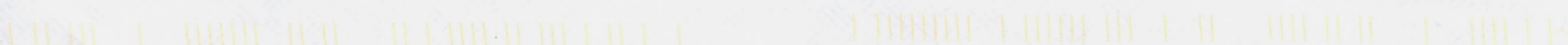
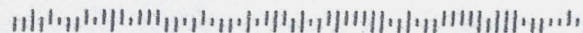



PRESTON L PIEPER  
200 HIGH CHAPARRAL  
PRESCOTT, AZ 86303-6356

PHOENIX AZ 852

23 AUG 2018 PM 8 L



BUREAU OF LAND MANAGEMENT  
ARIZONA STATE OFFICE  
1 NORTH CENTRAL AVENUE, SUITE 800  
PHOENIX, ARIZONA 85004

PHOENIX, ARIZONA

2018 AUG 24 P 1:43

RECEIVED  
BLM AZ STATE OFFICE

85004\$4427 C041



**United States Department of the Interior**  
**Bureau of Land Management**  
DIV OF LANDS, MINRLS & ENERGY  
ONE N CENTRAL AVE  
PHOENIX, AZ 85004 -4427  
Phone: 602-417-9200

Receipt

No: 4245903

Transaction #: 4361361

Date of Transaction: 08/27/2018

CUSTOMER:

Ac 480  
ENTERED AUG 30 2018  
FB

PRESTON PIEPER  
200 HIGH CHAPARRAL  
PRESCOTT, AZ 86303-6356 US

LINE #	QTY	DESCRIPTION	REMARKS	UNIT PRICE	TOTAL
1	1.00	LOCATABLE MINERALS / MINING CLAIMS- NOT NEW-UNADJUD, ONE AUTH NO. ONLY / MINING CLAIM MONEY RECEIVED CASES: AMC417461/\$40.00	POL 2018/4 WAV	- n/a -	40.00
TOTAL:					\$40.00

PAYMENT INFORMATION			
1	AMOUNT:	40.00	POSTMARKED: N/A
	TYPE:	CHECK	RECEIVED: 08/24/2018
	CHECK NO:	2566	
	NAME:	PIEPER, PRESTON 200 HIGH CHAPARRAL PRESCOTT AZ 86303-6356 US	

REMARKS

This receipt was generated by the automated BLM Collections and Billing System and is a paper representation of a portion of the official electronic record contained therein.



UNITED STATES  
DEPARTMENT OF THE INTERIOR  
BUREAU OF LAND MANAGEMENT

MAINTENANCE FEE WAIVER CERTIFICATION

SEE INSTRUCTIONS ON PAGE 2

FORM APPROVED  
OMB NO. 1004-0114  
Expires: January 31, 2020

417461  
412575

381462

1. This small miner waiver is filed for the assessment year beginning on September 1, 2018 and ending on September 1, 2019.
2. The undersigned and all related parties owned ten or fewer mining claims, mill, or tunnel sites located and maintained on Federal lands in the United States of America on September 1, 2018.
3. The undersigned have performed the assessment work required by law for each mining claim listed prior to filing this waiver and understand that by filing this form, the undersigned must file an affidavit of assessment work with the Bureau of Land Management (BLM) by the December 30th following the filing of this waiver.
4. The undersigned understand that if the assessment work obligation has not yet come due under 30 U.S.C. 28 (for those claims in their first assessment year only), a notice of intent to hold reciting this condition must be recorded by the December 30th following the filing of this waiver.
5. The undersigned understand that mill and tunnel sites may also be listed on this waiver and be waived from payment of the maintenance fee, and that a notice of intent to hold for these sites is required to be filed with the BLM by the December 30th following the filing of this waiver.
6. The undersigned understand and acknowledge that pursuant to 43 U.S.C. 1212 and 18 U.S.C. 1001, the filing or recording of a false, fictitious, or fraudulent document with the BLM may result in a fine of up to \$250,000, a prison term not to exceed five years, or both.
7. The mining claims, mill or tunnel sites for which this waiver from payment of the maintenance fees is requested are:

CLAIM OR SITE NAME	BLM RECORDATION SERIAL NUMBER
1. MPC D 3	AMC 417461 (913)
2. MPC D 2	AMC 412576
3. MPC D 1	AMC 412575
4. Big BEND (Big BEND)	AMC 381462
5.	
6.	
7.	
8.	
9.	
10.	

RECEIVED  
BLM AZ STATE OFFICE  
2018 SEP -5 P 2:08  
PHOENIX, ARIZONA

The owner(s) (claimant(s)) of the above mining claims and sites are:

dx PRESTON PIEPER ✓  
(Owner's Name - Please Print)

200 High Chaparral ✓  
(Owner's Mailing Address)

Prescott AZ 86303  
(City) (State) (Zip Code)

dx MARILYN PIEPER ✓  
(Owner's Name - Please Print)

(Owner's Mailing Address)

Marilyn Pieper  
(Owner's Signature)  
Prescott AZ 86303  
(City) (State) (Zip Code)

(Owner's Name - Please Print)

(Owner's Mailing Address)

(Owner's Signature)

(City)

(State)

(Zip Code)

(Owner's Name - Please Print)

(Owner's Mailing Address)

AC 483  
ENTERED SEP 13 2018

(City)

(State)

(Zip Code)



(Owner's Name - Please Print)

(Owner's Signature)

(Owner's Mailing Address)

(City)

(State)

(Zip Code)

(Owner's Name - Please Print)

(Owner's Signature)

(Owner's Mailing Address)

(City)

(State)

(Zip Code)

(Owner's Name - Please Print)

(Owner's Signature)

(Owner's Mailing Address)

(City)

(State)

(Zip Code)

(Owner's Name - Please Print)

(Owner's Signature)

(Owner's Mailing Address)

(City)

(State)

(Zip Code)

18 U.S.C. 1001 and 43 U.S.C. 1212 make it a crime for any person knowingly and willfully to make to any department or agency of the United States any false, fictitious or fraudulent statements or representations as to any matter within its jurisdiction.

#### INSTRUCTIONS

1. This certification is made under the provisions of 43 U.S.C. § 1744 and 30 U.S.C. § 28-28k and the regulations thereunder (43 CFR Part 3830).
2. The claimant(s) must fill in the dates in paragraph 1 for the beginning and ending of the assessment year for which this waiver is sought.
3. The claimant(s) must fill in the date in paragraph 2 for the beginning of the assessment year for which this waiver is sought.
4. All claim and site names and BLM serial numbers must be listed for the mining claims, mill sites, and tunnel sites for which the waiver is sought.
5. All owners of the mining claims, mill sites, and tunnel sites and their addresses must be given.
6. This waiver form must be signed by all the claimants or their designated agent, in original form. If an agent is designated, a notarized designation of agent, signed by all of the claimants with proper address given, must be submitted with this waiver.
7. This form must be filed no later than September 1st for the upcoming assessment year in the BLM State Office where the mining claims or sites are recorded, or the waiver cannot be granted by the BLM. (Example: To obtain a waiver for the assessment year 2012, which begins on September 1, 2011, you must qualify for and file for a waiver no later than September 1, 2011, in the proper BLM State Office.)
8. For all mining claims which require assessment work, you must record an affidavit of labor on or before the December 30th immediately following the filing of this waiver. For all other mining claims or sites waived, you must record a notice of intent to hold on or before the December 30th immediately following the filing of this waiver.
9. Mill and tunnel sites may also be listed on this waiver and be waived from payment of the maintenance fee. A notice of intent to hold for these sites is required to be filed by the December 30th following the filing of this waiver.

**POSTMARKED  
TIMELY**

FOR OFFICIAL USE ONLY



RECEIVED  
BLM AZ STATE OFFICE  
2010 SEP -5 P 2:08  
PHOENIX, ARIZONA

Dept OF THE INTERIOR  
BLM  
ARIZONA STATE OFFICE  
ONE NORTH CENTRAL AVE, SUITE 800  
PHOENIX, ARIZONA 85004-4427

UNITED STATES  
DEPARTMENT OF THE INTERIOR  
BUREAU OF LAND MANAGEMENT

MAINTENANCE FEE WAIVER CERTIFICATION

SEE INSTRUCTIONS ON PAGE 2

FORM APPROVED  
OMB NO. 1004-0114

Expires:

Current form expires 9/5/18 381462

1. This small miner waiver is filed for the assessment year beginning on September 1, 2018 and ending on September 1, 2019
2. The undersigned and all related parties owned ten or fewer mining claims, mill, or tunnel sites located and maintained on Federal lands in the United States of America on September 1, 2018.
3. The undersigned have performed the assessment work required by law for each mining claim listed prior to filing this waiver and understand that by filing this form, the undersigned must file an affidavit of assessment work with the Bureau of Land Management (BLM) by the December 30th following the filing of this waiver.
4. The undersigned understand that if the assessment work obligation has not yet come due under 30 U.S.C. 28 (for those claims in their first assessment year only), a notice of intent to hold reciting this condition must be recorded by the December 30th following the filing of this waiver.
5. The undersigned understand that mill and tunnel sites may also be listed on this waiver and be waived from payment of the maintenance fee, and that a notice of intent to hold for these sites is required to be filed with the BLM by the December 30th following the filing of this waiver.
6. The undersigned understand and acknowledge that pursuant to 43 U.S.C. 1212 and 18 U.S.C. 1001, the filing or recording of a false, fictitious, or fraudulent document with the BLM may result in a fine of up to \$250,000, a prison term not to exceed five years, or both.
7. The mining claims, mill or tunnel sites for which this waiver from payment of the maintenance fees is requested are:

CLAIM OR SITE NAME	BLM RECORDATION SERIAL NUMBER
1. MPC D 3	AME 417461 (913)
2. MPC D 2	AME 412576
3. MPC D 1	AME 412575
4. Big BEND	AME 381462
5.	
6.	
7.	
8.	
9.	
10.	

RECEIVED  
BLM AZ STATE OFFICE  
2018 AUG 24 P 4:43  
PHOENIX, ARIZONA

The owner(s) (claimants) of the above mining claims and sites are:

PRESTON PIEPER  
(Owner's Name - Please Print)  
200 HIGH CHAPARRAL  
(Owner's Mailing Address)

PRESCOTT  
(City) AZ 86303  
(State) (Zip Code)

MARILYN PIEPER  
(Owner's Name - Please Print)  
200 HIGH CHAPARRAL  
(Owner's Mailing Address)

PRESCOTT  
(City) AZ 86303  
(State) (Zip Code)

(Owner's Name - Please Print)

(Owner's Signature)

(Owner's Mailing Address)

(City)

(State)

(Zip Code)

(Owner's Name - Please Print)

(Owner's Signature)

(Owner's Mailing Address)

(City)

(State)

(Zip Code)

(Continued on page 2)

ENTERED  
Form w/Exr dates  
SEP 13 2018  
Rec'd 9/15/18  
BY: [Signature]

#4245903

(Owner's Name - Please Print)

(Owner's Signature)

(Owner's Mailing Address)

(City)

(State)

(Zip Code)

(Owner's Name - Please Print)

(Owner's Signature)

(Owner's Mailing Address)

(City)

(State)

(Zip Code)

(Owner's Name - Please Print)

(Owner's Signature)

(Owner's Mailing Address)

(City)

(State)

(Zip Code)

(Owner's Name - Please Print)

(Owner's Signature)

(Owner's Mailing Address)

(City)

(State)

(Zip Code)

18 U.S.C. 1001 and 43 U.S.C. 1212 make it a crime for any person knowingly and willfully to make to any department or agency of the United States any false, fictitious or fraudulent statements or representations as to any matter within its jurisdiction.

#### INSTRUCTIONS

1. This certification is made under the provisions of 43 U.S.C. § 1744 and 30 U.S.C. §28-28k and the regulations thereunder (43 CFR Part 3830).
2. The claimant(s) must fill in the dates in paragraph 1 for the beginning and ending of the assessment year for which this waiver is sought.
3. The claimant(s) must fill in the date in paragraph 2 for the beginning of the assessment year for which this waiver is sought.
4. All claim and site names and BLM serial numbers must be listed for the mining claims, mill sites, and tunnel sites for which the waiver is sought.
5. All owners of the mining claims, mill sites, and tunnel sites and their addresses must be given.
6. This waiver form must be signed by all the claimants or their designated agent, in original form. If an agent is designated, a notarized designation of agent, signed by all of the claimants with proper address given, must be submitted with this waiver.
7. This form must be filed no later than September 1st for the upcoming assessment year in the BLM State Office where the mining claims or sites are recorded, or the waiver cannot be granted by the BLM. (Example: To obtain a waiver for the assessment year 2012, which begins on September 1, 2011, you must qualify for and file for a waiver no later than September 1, 2011, in the proper BLM State Office.)
8. For all mining claims which require assessment work, you must record an affidavit of labor on or before the December 30th immediately following the filing of this waiver. For all other mining claims or sites waived, you must record a notice of intent to hold on or before the December 30th immediately following the filing of this waiver.
9. Mill and tunnel sites may also be listed on this waiver and be waived from payment of the maintenance fee. A notice of intent to hold for these sites is required to be filed by the December 30th following the filing of this waiver.

FOR OFFICIAL USE ONLY

UNITED STATES  
DEPARTMENT OF THE INTERIOR  
BUREAU OF LAND MANAGEMENT

MAINTENANCE FEE WAIVER CERTIFICATION

SEE INSTRUCTIONS ON PAGE 2

80

417461  
412575

FORM APPROVED  
OMB NO. 1004-0114  
Expires: October 31, 2016

381462

1. This small miner waiver is filed for the assessment year beginning on September 1, 2017 and ending on September 1, 2018.
2. The undersigned and all related parties owned ten or fewer mining claims, mill, or tunnel sites located and maintained on Federal lands in the United States of America on September 1, 2017.
3. The undersigned have performed the assessment work required by law for each mining claim listed prior to filing this waiver and understand that by filing this form the undersigned must file an affidavit of assessment work with the Bureau of Land Management (BLM) by the December 30th following the filing of this waiver.
4. The undersigned understand that if the assessment work obligation has not yet come due under 30 U.S.C. 28 (for those claims in their first assessment year only), a notice of intent to hold reciting this condition must be recorded by the December 30th following the filing of this waiver.
5. The undersigned understand that mill and tunnel sites may also be listed on this waiver and be waived from payment of the maintenance fee, and that a notice of intent to hold for these sites is required to be filed with the BLM by the December 30th following the filing of this waiver.
6. The undersigned understand and acknowledge that pursuant to 43 U.S.C. 1212 and 18 U.S.C. 1001, the filing or recording of a false, fictitious, or fraudulent document with the BLM may result in a fine of up to \$250,000, a prison term not to exceed five years, or both.
7. The mining claims, mill or tunnel sites for which this waiver from payment of the maintenance fees is requested are:

CLAIM OR SITE NAME	BLM RECORDATION SERIAL NUMBER
1. <u>MPCD 3</u>	<u>AMC 417461</u>
2. <u>MPCD 2</u>	<u>AMC 412576</u>
3. <u>MPCD 1</u>	<u>AMC 412575</u>
4. <u>Big BEND</u>	<u>AMC 381462</u>
5.	
6.	
7.	
8.	
9.	
10.	

The owner(s) (claimants) of the above mining claims and sites are:

NW check  
4 ct PRESTON PIERER  
(Owner's Name - Please Print)

Prescott  
(Owner's Signature)

200 HIGH CHAPARRAL  
(Owner's Mailing Address)

PRESCOTT AZ 86303  
(City) (State) (Zip Code)

4 ct MARILYN PIERER  
(Owner's Name - Please Print)

Marilyn Pierer  
(Owner's Signature)

200 HIGH CHAPARRAL  
(Owner's Mailing Address)

PRESCOTT AZ 86303  
(City) (State) (Zip Code)

ENTERED  
AC 483 (2018)  
AUG 31 2017  
BY: PR

(Owner's Name - Please Print)

(Owner's Signature)

(Owner's Mailing Address)

(City) (State) (Zip Code)

(Owner's Name - Please Print)

(Owner's Signature)

(Owner's Mailing Address)

(City) (State) (Zip Code)



(Owner's Name - Please Print)

(Owner's Signature)

(Owner's Mailing Address)

(City)

(State)

(Zip Code)

(Owner's Name - Please Print)

(Owner's Signature)

(Owner's Mailing Address)

(City)

(State)

(Zip Code)

(Owner's Name - Please Print)

(Owner's Signature)

(Owner's Mailing Address)

(City)

(State)

(Zip Code)

(Owner's Name - Please Print)

(Owner's Signature)

(Owner's Mailing Address)

(City)

(State)

(Zip Code)

18 U.S.C. 1001 and 43 U.S.C. 1212 make it a crime for any person knowingly and willfully to make to any department or agency of the United States any false, fictitious or fraudulent statements or representations as to any matter within its jurisdiction.

#### INSTRUCTIONS

1. This certification is made under the provisions of 43 U.S.C. § 1744 and 30 U.S.C. §28-28k and the regulations thereunder (43 CFR Part 3830).
2. The claimant(s) must fill in the dates in paragraph 1 for the beginning and ending of the assessment year for which this waiver is sought.
3. The claimant(s) must fill in the date in paragraph 2 for the beginning of the assessment year for which this waiver is sought.
4. All claim and site names and BLM serial numbers must be listed for the mining claims, mill sites, and tunnel sites for which the waiver is sought.
5. All owners of the mining claims, mill sites, and tunnel sites and their addresses must be given.
6. This waiver form must be signed by all the claimants or their designated agent, in original form. If an agent is designated, a notarized designation of agent, signed by all of the claimants with proper address given, must be submitted with this waiver.
7. This form must be filed no later than September 1st for the upcoming assessment year in the BLM State Office where the mining claims or sites are recorded, or the waiver cannot be granted by the BLM. (Example: To obtain a waiver for the assessment year 2012, which begins on September 1, 2011, you must qualify for and file for a waiver no later than September 1, 2011, in the proper BLM State Office.)
8. For all mining claims which require assessment work, you must record an affidavit of labor on or before the December 30th immediately following the filing of this waiver. For all other mining claims or sites waived, you must record a notice of intent to hold on or before the December 30th immediately following the filing of this waiver.
9. Mill and tunnel sites may also be listed on this waiver and be waived from payment of the maintenance fee. A notice of intent to hold for these sites is required to be filed by the December 30th following the filing of this waiver.

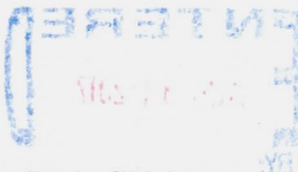

FOR OFFICIAL USE ONLY

2011 JUL 2 P 2:37  
PHOENIX, ARIZONA  
BLM STATE OFFICE  
RECEIVED



UNITED STATES DEPARTMENT OF THE INTERIOR  
BUREAU OF LAND MANAGEMENT

MC NATIONWIDE CLAIMANT LISTING  
August 31, 2017

Cust	AZ CLAIMANT	National Total
PIEPER MARILYN 200 HIGH CHAPARRAL PRESCOTT, AZ 86303-6356	4	4
PIEPER PRESTON L 200 HIGH CHAPARRAL PRESCOTT, AZ 86303-6356	4	4

Run Date: 08/31/17

DEPARTMENT OF THE INTERIOR  
BUREAU OF LAND MANAGEMENT  
MINING CLAIMS

Run Time: 02:31 PM

MC Customer Information - With Serial No. and Claim Name  
ACTIVE CLAIMS

Page 1 of 1

Admin State: AZ

Geo State: AZ

PIEPER MARILYN  
200 HIGH CHAPARRAL  
PRESCOTT, AZ 86303-6356

CUSTOMER ID: 2238588

<u>Serial No.</u>	<u>Claim Name/Number</u>	<u>Lead Serial No.</u>	<u>Disposition</u>
AMC381462	BIG BEND	AMC381462	ACTIVE
AMC412575	MPCD 1	AMC412575	ACTIVE
AMC412576	MPCD 2	AMC412575	ACTIVE
AMC417461	MPCD 3	AMC417461	ACTIVE

Number of ACTIVE cases: 4

PIEPER PRESTON L  
200 HIGH CHAPARRAL  
PRESCOTT, AZ 86303-6356

CUSTOMER ID: 2238587

<u>Serial No.</u>	<u>Claim Name/Number</u>	<u>Lead Serial No.</u>	<u>Disposition</u>
AMC381462	BIG BEND	AMC381462	ACTIVE
AMC412575	MPCD 1	AMC412575	ACTIVE
AMC412576	MPCD 2	AMC412575	ACTIVE
AMC417461	MPCD 3	AMC417461	ACTIVE

Number of ACTIVE cases: 4

**AFFIDAVIT OF ANNUAL ASSESSMENT WORK**

412575  
381462

2017-0034602 ADL  
07/10/2017 09:08:22 AM Page: 1 of 5  
Leslie M. Hoffman  
OFFICIAL RECORDS OF YAVAPAI COUNTY \$15.00  
PRESTON PIEPER

**WHEN RECORDED, MAIL DOCUMENT TO:**

NAME: PRESTON PIEPER

ADDRESS: 200 High CHAPARRAL

CITY, STATE, ZIP: PRESCOTT, AZ, 86303

**FOR COUNTY RECORDER'S USE**

No. of Claims 4

x \$10/claim

Total due BLM \$ 40.00

**TO ALL WHOM IT MAY CONCERN:**

1. The undersigned certifies that at least \$100 per claim was expended for development, labor and improvements, or equivalent value added, as the annual assessment work for the assessment year ending September 1, 2017 for the following contiguous unpatented mining claim(s), located in the County of YAVAPAI, in the State of ARIZONA.

"Amc" BLM Serial No.	Name of Claim	Tp	Rg	Sec	Mer	County Recordation Book and Page No.	Date
412575	MPCD 1	10N	2E	31	14	4843 857	9/4/12
412576	MPCD 2	10N	2E	32	14	4843 856	9/4/12
417461	MPCD 3	10N	2E	31	14	4903 346	9/4/12
381462	Big BEND	10N	2E	32	14	4492 514	

(Continued on page 2)

ENTERED  
JUL 25 2017  
BY: RIAM

PLO

2. Type of labor and improvements (specify what was done and give the total value for that labor and improvement to show at least \$100 for each claim). If a geological, geochemical, or geophysical survey was performed, as per 30 U.S.C. 28-1, reference the title of the report of survey, give cost and date of the survey and report, and indicate it was filed with the County Recorder:

Description of Work Performed	Value of Work Performed	Date Work Was Performed
ROAD REPAIRS MPCD 1-3 & Big Bend	\$ 500 <sup>00</sup>	3-19-17-3-22-17
Rephrased Signs SHOT BY SHOOTERS (3)	\$ 27 <sup>00</sup>	3-20-17
ACTIVE MINING / Sampling AZA 36421		
NWP # SPL-2011-00531-MWL		

3. Name and mailing address of each person who performed the labor and improvements:

Name (please print)

PRESTON PIERCE  
SHAWN ANTHONY  
DAVID RIDENHOUR

Current Mailing Address (please print)

200 HIGH CHAPARRAL PRESCOTT, AZ 86303  
200 HIGH CHAPARRAL PRESCOTT, AZ 86303  
700 W. CHENOKEE PRESCOTT, AZ 86303

4. Name and mailing address of each person who holds and claims the subject mining claim(s) for the valuable minerals contained therein. Be sure to indicate if there is a change of address:

Name (please print)

MARILYN PIERCE  
PRESTON PIERCE

Current Mailing Address (please print)

200 HIGH CHAPARRAL PRESCOTT, AZ 86303  
200 HIGH CHAPARRAL PRESCOTT, AZ 86303

5. The undersigned testifies that on the date of \_\_\_\_\_, 20\_\_\_\_, all monuments required by law were erected upon the subject claim(s), and all notices required by law were posted on the subject claim(s) or copies thereof were in place, and at said date, each corner monument bore or contained



markings sufficient to appropriately designate the corner of the claim to which it pertains and the name of the claim(s).

I hereby certify under penalty of perjury under the laws of the State of ARIZONA that the foregoing statements are true and correct:

(Signature of person responsible for above statement)

Date:

7-10-17

Title 18 U.S.C. 1001 and 43 U.S.C. 1212 make it a crime for any person knowingly and willfully to make to any department or agency of the United States any false, fictitious or fraudulent statements or representations as to any matter within its jurisdiction.

### Notary Block

SUBSCRIBED AND SWORN TO before me, this 10<sup>th</sup> day of July 20 17

By:

(Signature of Affiant)

Title:

Notary Public

My Commission Expires:

March 2, 2019



Cynthia Hathaway  
Notary Public  
Yavapai County, Arizona  
My Comm. Expires  
03-02-2019

### INSTRUCTIONS

1. This is an optional form that may be used to satisfy the requirements for the Bureau of Land Management (BLM) under the provisions of 43 U.S.C. §1744 and 30 U.S.C. §28-28d and the regulations thereunder (43 CFR part 3835). Since local and State laws may vary, you should contact your local and State agencies where the claims are located to ensure all applicable laws and requirements are satisfied.
2. The claimant(s) must fill in the date in paragraph 1 for the applicable assessment year and the county and state where the claims are located.
3. All claim names, BLM serial numbers, legal descriptions, and original county recording information must be listed for the claims pertaining to this assessment notice.
4. The claimant(s) must complete paragraph 2 listing all labor or improvements which was performed on or did benefit the subject mining claims. The value and date of the labor or improvements must also be listed. The total amount of labor or improvements can be listed, but the total expenditure must equal at least \$100 for each claim.
5. The names and current mailing addresses of the person(s) performing the labor shall be listed in paragraph 3.
6. The name and current mailing address of each owner (claimant) of the claims shall be listed in paragraph 4. The mailing address shall be the owner's address and not the address of an agent or anyone representing the claimant. Be sure to note if there has been a change of address.
7. Paragraph 5 shall be completed to show the date it was verified that all monuments required by law were properly erected, all notices were posted, and that corners were appropriately designated for all claims listed.
8. An exact legible reproduction or duplicate (other than microfilm or other electronic media) of this affidavit or another type of affidavit of assessment work that you file or will file in the county where each claim is located, must be filed with the BLM on or before December 30 of the calendar year in which the assessment year ends. For mill or tunnel sites, a separate notice of intent to hold must be filed with the BLM on or before December 30. Requirements for filing a notice of intent to hold can be found at 43 CFR 3835.33.
9. A processing fee of \$10 for each claim listed must be remitted to the BLM along with this or any other affidavit of assessment work.

## NOTICES

**THE PRIVACY ACT** and 43 CFR 2.48(d) require that you be furnished with the following information in connection with the information requested by this form.

**AUTHORITY:** 30 U.S.C. §28-28d and 43 CFR part 3835 permit collection of the information requested by this form.

**PRINCIPAL PURPOSE:** The BLM will use the information you provide to document compliance with 43 U.S.C. 1744 and that assessment work has been completed in accordance with 30 U.S.C. § 28-28d and 43 CFR part 3835 in lieu of paying the maintenance fee for the mining claims listed on this form.

**ROUTINE USES:** The BLM will only disclose this information in accordance with the provisions at 43 CFR 2.56(b) and (c).

**EFFECT OF NOT PROVIDING INFORMATION:** Disclosure of the requested information is required by 30 U.S.C. § 28-28d and 43 CFR part 3835 for claimants qualified to perform assessment work in lieu of paying the maintenance fee. Failure to submit all the requested information or to complete this form will delay the BLM's processing of the form and may preclude the BLM's acceptance of the assessment work information, which may result in forfeiture of the mining claim(s) by the claimant.

**THE PAPERWORK REDUCTION ACT** requires us to inform you that:

Use of this form is optional. You must perform assessment if a waiver to pay the maintenance fee has been requested. This form is provided to help you attest that annual assessment work has been completed in lieu of paying the maintenance fee for your claim(s). Submission of the requested information is necessary to obtain or retain a benefit.

You do not have to respond to this or any other Federal agency-sponsored information collection unless it displays a valid OMB control number.

**BURDEN HOURS STATEMENT:** The estimated public reporting burden for this form is 30 minutes per response, including the time for reviewing instructions, gathering and maintaining data, and completing and reviewing the form. You may submit comments regarding the burden estimate or any other aspect of this form to: U.S. Department of the Interior, Bureau of Land Management (1004-0114), Bureau Information Collection Clearance Officer (WO-630), 1849 C Street, N.W., Room 2134LM, Washington, D.C. 20240.

RECEIVED  
BLM, BUREAU OF LAND MANAGEMENT  
2017 JUL 21 P 2:38  
HELEN, MINZON



Preston & Marilyn Pieper  
200 High Chaparral Loop  
Prescott, AZ 86303

PHOENIX, AZ 850

20 JUL 2017 PM 8:1

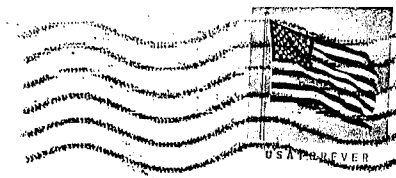

AZ BLM  
LANDS/RECREATION & PLANNING  
ONE N. CENTRAL AVE, SUITE 800  
PHOENIX, AZ 85004-4427

RECEIVED  
BLM AZ REGION  
2017 JUL 21 P 2:37  
PHOENIX, ARIZONA

85004-442700

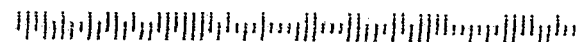

**United States Department of the Interior**  
**Bureau of Land Management**  
DIV OF LANDS, MINRLS & ENERGY  
ONE N CENTRAL AVE  
PHOENIX, AZ 85004 -4427  
Phone: 602-417-9200

Receipt

No: 3901809

<b>Transaction #:</b> 4011168	
<b>Date of Transaction:</b> 07/24/2017	
<b>CUSTOMER:</b>	
	PRESTON PIEPER 200 HIGH CHAPARRAL PRESCOTT, AZ 86303-6356 US

LINE #	QTY	DESCRIPTION	REMARKS	UNIT PRICE	TOTAL
1	1.00	LOCATABLE MINERALS / MINING CLAIMS- NOT NEW-UNADJUD, ONE AUTH NO. ONLY / MINING CLAIM MONEY RECEIVED CASES: AMC417461/\$40.00	POL 2017/4 WAV	- n/a -	40.00
<b>TOTAL:</b>					<b>\$40.00</b>

PAYMENT INFORMATION				
1	AMOUNT:	40.00	POSTMARKED:	07/20/2017
	TYPE:	CHECK	RECEIVED:	07/21/2017
	CHECK NO:	2555		
	NAME:	PIEPER, PRESTON L 200 HIGH CHAPARRAL PRESCOTT AZ 86303-6356 US		

REMARKS

This receipt was generated by the automated BLM Collections and Billing System and is a paper representation of a portion of the official electronic record contained therein.

UNITED STATES  
DEPARTMENT OF THE INTERIOR  
BUREAU OF LAND MANAGEMENT  
**MAINTENANCE FEE WAIVER CERTIFICATION**

[280]

381462  
412575  
417461  
FORM APPROVED  
OMB NO. 1004-0114  
Expires: October 31, 2016

SEE INSTRUCTIONS ON PAGE 2

1. This small miner waiver is filed for the assessment year beginning on September 1, 2016 and ending on September 1, 2017.
2. The undersigned and all related parties owned ten or fewer mining claims, mill, or tunnel sites located and maintained on Federal lands in the United States of America on September 1, 2016.
3. The undersigned have performed the assessment work required by law for each mining claim listed prior to filing this waiver and understand that by filing this form, the undersigned must file an affidavit of assessment work with the Bureau of Land Management (BLM) by the December 30th following the filing of this waiver.
4. The undersigned understand that if the assessment work obligation has not yet come due under 30 U.S.C. 28 (for those claims in their first assessment year only), a notice of intent to hold reciting this condition must be recorded by the December 30th following the filing of this waiver.
5. The undersigned understand that mill and tunnel sites may also be listed on this waiver and be waived from payment of the maintenance fee, and that a notice of intent to hold for these sites is required to be filed with the BLM by the December 30th following the filing of this waiver.
6. The undersigned understand and acknowledge that pursuant to 43 U.S.C. 1212 and 18 U.S.C. 1001, the filing or recording of a false, fictitious, or fraudulent document with the BLM may result in a fine of up to \$250,000, a prison term not to exceed five years, or both.
7. The mining claims, mill or tunnel sites for which this waiver from payment of the maintenance fees is requested are:

CLAIM OR SITE NAME	BLM RECORDATION SERIAL NUMBER
1. <u>Big BEND</u>	<u>AMC 381462</u> ✓
2. <u>MPCD 1</u>	<u>AMC 411575</u>
3. <u>MPCD 2</u>	<u>AMC 411576</u>
4. <u>MPCD 3</u>	<u>AMC 411577</u>
5.	
6.	
7.	
8.	
9.	
10.	

The owner(s) (claimants) of the above mining claims and sites are:

PRESTON PIEPER  
(Owner's Name - Please Print)  
200 High CHAPARRAL  
(Owner's Mailing Address)

Prescott  
(Owner's Signature)  
PRESCOTT AZ 86303  
(City) (State) (Zip Code)

MARILYN PIEPER  
(Owner's Name - Please Print)  
200 High CHAPARRAL  
(Owner's Mailing Address)

Marilyn Pieper  
(Owner's Signature)  
PRESCOTT AZ 86303  
(City) (State) (Zip Code)

\_\_\_\_\_  
(Owner's Name - Please Print)  
\_\_\_\_\_  
(Owner's Mailing Address)

\_\_\_\_\_  
(Owner's Signature)  
\_\_\_\_\_  
(City) (State) (Zip Code)

\_\_\_\_\_  
(Owner's Name - Please Print)  
\_\_\_\_\_  
(Owner's Mailing Address)

\_\_\_\_\_  
(Owner's Signature)  
\_\_\_\_\_  
(City) (State) (Zip Code)

(Continued on page 2)

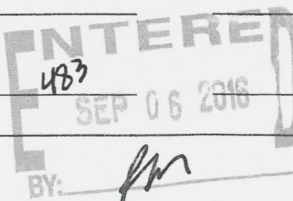

mw  
h

Form 3830-4  
(October 2013)

UNITED STATES  
DEPARTMENT OF THE INTERIOR  
BUREAU OF LAND MANAGEMENT

AFFIDAVIT OF ANNUAL ASSESSMENT WORK

FORM APPROVED  
OMB NO.: 1004-0114  
Expires: October 31, 2016

381462  
412575  
417461

WHEN RECORDED, MAIL DOCUMENT TO:

NAME: PRESTON PIEPER

ADDRESS: 200 High CHAPARRAL

CITY, STATE, ZIP: PRESCOTT, AZ 86303

FOR COUNTY RECORDER'S USE

RECEIPT # 3633801

No. of Claims 4

x \$10/claim

Total due BLM \$ 40.00

TO ALL WHOM IT MAY CONCERN:

1. The undersigned certifies that at least \$100 per claim was expended for development, labor and improvements, or equivalent value added, as the annual assessment work for the assessment year ending September 1, 2016 for the following contiguous unpatented mining claim(s), located in the County of YAVAPAI, in the State of ARIZONA.

BLM Serial No.	Name of Claim	Tp	Rg	Sec	Mer	County Recordation Book and Page No.	Date
381462	Big BEND	10N	2E	32	14	4492 514	
412575	MPCD 1	10N	2E	31	14	4843 857	9-4-12
412576	MPCD 2	10N	2E	32	14	4843 856	9-4-12
417461	MPCD 3	10N	2E	31	14	4903 346	9-4-12

RECEIVED  
BLM STATE OFFICE  
2016 AUG 17 P 2:19  
PHOENIX, ARIZONA



2. Type of labor and improvements (specify what was done and give the total value for that labor and improvement to show at least \$100 for each claim). If a geological, geochemical, or geophysical survey was performed, as per 30 U.S.C. 28-1, reference the title of the report of survey, give cost and date of the survey and report, and indicate it was filed with the County Recorder:

Description of Work Performed	Value of Work Performed	Date Work Was Performed
MPC01 - Repairing Roads - Mini Tractor	\$ 150	MAY 7, 8, 9 <sup>th</sup> 2016
MPC02 Repairing Roads - Mini Tractor	\$ 150	MAY 7, 8, 9 <sup>th</sup> 2016
MPC03 Repairing Roads - Mini Tractor	\$ 150	MAY 7, 8, 9 <sup>th</sup> 2016
Big Band Repairing Roads - Mini Tractor	\$ 150	MAY 7, 8, 9 <sup>th</sup> 2016

3. Name and mailing address of each person who performed the labor and improvements:

Name (please print)

JAMES RIDENHOUR  
BILL COFFEE

Current Mailing Address (please print)

700 W. CHEROKEE PRESCOTT AZ 86303  
824 E. PINE KNOLL PRESCOTT AZ 86303

4. Name and mailing address of each person who holds and claims the subject mining claim(s) for the valuable minerals contained therein. Be sure to indicate if there is a change of address:

Name (please print)

PRESTON PIEPER  
MARILYN PIEPER

Current Mailing Address (please print)

200 HIGH CHAPARRAL, PRESCOTT, AZ 86303  
200 HIGH CHAPARRAL, PRESCOTT, AZ 86303

RECEIVED  
BLM AZ STATE OFFICE  
2016 AUG 17 P 2:15  
PHOENIX, ARIZONA

5. The undersigned testifies that on the date of May, 2016, monuments required by law were erected upon the subject claim(s), and all notices required by law were posted on the subject claim(s) or copies thereof were in place, and at said date, each corner monument bore or contained



markings sufficient to appropriately designate the corner of the claim to which it pertains and the name of the claim(s).

I hereby certify under penalty of perjury under the laws of the State of ARIZONA that the foregoing statements are true and correct:

(Signature of person responsible for above statement)

Date: PHOENIX, ARIZONA

Title 18 U.S.C. 1001 and 43 U.S.C. 1212 make it a crime for any person knowingly and willfully to make to any department or agency of the United States any false, fictitious or fraudulent statements or representations as to any matter within its jurisdiction.

### Notary Block

SUBSCRIBED AND SWORN TO before me, this 25<sup>th</sup> day of July 20 16

By: Celia Lay  
(Signature of Affiant)

Title: Notary Public

My Commission Expires: 04.28.20

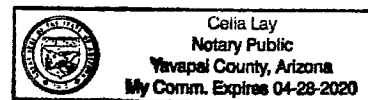

### INSTRUCTIONS

1. This is an optional form that may be used to satisfy the requirements for the Bureau of Land Management (BLM) under the provisions of 43 U.S.C. §1744 and 30 U.S.C. §28-28d and the regulations thereunder (43 CFR part 3835). Since local and State laws may vary, you should contact your local and State agencies where the claims are located to ensure all applicable laws and requirements are satisfied.
2. The claimant(s) must fill in the date in paragraph 1 for the applicable assessment year and the county and state where the claims are located.
3. All claim names, BLM serial numbers, legal descriptions, and original county recording information must be listed for the claims pertaining to this assessment notice.
4. The claimant(s) must complete paragraph 2 listing all labor or improvements which was performed on or did benefit the subject mining claims. The value and date of the labor or improvements must also be listed. The total amount of labor or improvements can be listed, but the total expenditure must equal at least \$100 for each claim.
5. The names and current mailing addresses of the person(s) performing the labor shall be listed in paragraph 3.
6. The name and current mailing address of each owner (claimant) of the claims shall be listed in paragraph 4. The mailing address shall be the owner's address and not the address of an agent or anyone representing the claimant. Be sure to note if there has been a change of address.
7. Paragraph 5 shall be completed to show the date it was verified that all monuments required by law were properly erected, all notices were posted, and that corners were appropriately designated for all claims listed.
8. An exact legible reproduction or duplicate (other than microfilm or other electronic media) of this affidavit or another type of affidavit of assessment work that you file or will file in the county where each claim is located, must be filed with the BLM on or before December 30 of the calendar year in which the assessment year ends. For mill or tunnel sites, a separate notice of intent to hold must be filed with the BLM on or before December 30. Requirements for filing a notice of intent to hold can be found at 43 CFR 3835.33.
9. A processing fee of \$10 for each claim listed must be remitted to the BLM along with this or any other affidavit of assessment work.



**NOTICE OF INTENTION TO HOLD MINING CLAIMS/SITES**

When Recorded Return Document to:

PRESTON PIEPER  
200 HIGH CHAPARRAL  
PRESCOTT, AZ 86303

☐ Check here if this is a change of address.

Telephone: \_\_\_\_\_

E-mail Address: \_\_\_\_\_

RECEIVED  
 BLM AZ STATE OFFICE  
 2016 AUG 17 P 2:16  
 PHOENIX, ARIZONA  
 BLM  
 Date  
 Stamp

I (We) intend to hold the claims(s) and/or site(s) listed below for the calendar year 2016, and I (We) have filed or will file a Notice of Intent to Hold in the county where the claim (s) is located.

Reason for filing a Notice of Intent to Hold instead of an assessment work filing (check one):

- ☒ Maintenance fee was paid to maintain claim(s) during this assessment year.
- ☐ Mill or tunnel sites.
- ☐ Claim(s) was located during the current assessment year.
- ☐ BLM has deferred assessment work (attach copy of decision granting deferment, or pending petition for deferment including date petition was filed.)

Line No.	AMC NUMBER	CLAIM/SITE NAME	COUNTY RECORDER DATA (If available)	TWP	RNG	SEC
1	381462	Big BEND	YAVAPAI 4492 514	10N	2E	32
2						
3						
4						
5						
6						
7						
8						
9						
10						

NOTICE OF INTENTION TO HOLD MINING CLAIMS/SITES  
page 2

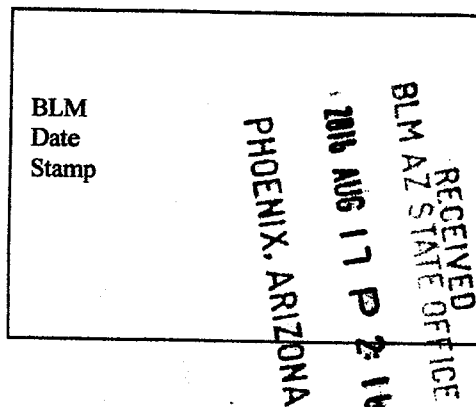

1. State of Arizona County of YAVAPAI

2. I (Name) PRESTON PIEPER

3. Reside at (Address) 200 HIGH CHAPARRAL

City PRESCOTT County YAVAPAI State AZ Zip 86303 being duly sworn, depose and say that I am a citizen of the United States, more than eighteen years of age, that all of the facts set forth in this notice, subject to the provisions and penalties of 18 U.S.C. 1001 pertaining to the filing of false, fictitious, or fraudulent statements with the United States, are true and correct according to the best of my knowledge, information and belief.

4. Owner's name and address (If not shown in Items 1-3 above). MARILYN PIEPER

200 HIGH CHAPARRAL PRESCOTT, AZ 86303

5. Dated: 7-25-16 Signature: [Signature]

Bureau of Land Management  
Arizona State Office  
[www.blm.gov/az](http://www.blm.gov/az)

No. of Claims:	<u>1</u>	x \$10 =	<u>\$10.00</u>
Check No:	<u>1003</u>	Init.	<u>AM</u>
Receipt No.:	<u>3633801</u>		
For BLM Use Only			

United States Department of the Interior  
Bureau of Land Management  
DIV OF LANDS, MINRLS & ENERGY  
ONE N CENTRAL AVE  
PHOENIX, AZ 85004 -4427  
Phone: 602-417-9200

Receipt

No: 3633801

Transaction #: 3737281

Date of Transaction: 08/17/2016

CUSTOMER:

PRESTON PIEPER  
200 HIGH CHAPARRAL  
PRESCOTT, AZ 86303-6356 US

LINE #	QTY	DESCRIPTION	REMARKS	UNIT PRICE	TOTAL
1	1.00	LOCATABLE MINERALS / MINING CLAIMS-NOT NEW-UNADJUD, ONE AUTH NO. ONLY / MINING CLAIM MONEY RECEIVED CASES: AMC381462/\$50.00	WAIVER 2017 - 4 / POL 2016 - 4 / NOI 2016 - 1	- n/a -	50.00
TOTAL:					\$50.00

PAYMENT INFORMATION

1	AMOUNT:	50.00	POSTMARKED:	N/A
	TYPE:	CHECK	RECEIVED:	08/17/2016
	CHECK NO:	1003		
	NAME:	PIEPER, PRESTON L 200 HIGH CHAPARRAL PRESCOTT AZ 86303-6356 US		

REMARKS

This receipt was generated by the automated BLM Collections and Billing System and is a paper representation of a portion of the official electronic record contained therein.

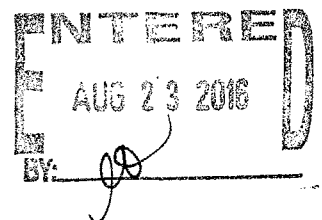

Preston & Marilyn Pieper  
200 High Chaparral Loop  
Prescott, AZ 86303



RECEIVED  
BLM AZ STATE OFFICE

2016 AUG 17 P 2 15

PHOENIX, ARIZONA

BLM ARIZONA STATE OFFICE  
ONE NORTH CENTRAL AVE. SUITE 800  
PHOENIX, AZ 85004-4427

8500434427 C041

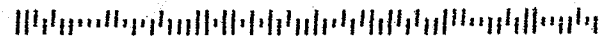



UNITED STATES  
DEPARTMENT OF THE INTERIOR  
BUREAU OF LAND MANAGEMENT

193

*[Handwritten signature]*

MAINTENANCE FEE WAIVER CERTIFICATION

FORM APPROVED  
OMB NO. 1004-0114  
Expires: October 31, 2016

412575  
381462

417461

SEE INSTRUCTIONS ON PAGE 2

1. This small miner waiver is filed for the assessment year beginning on September 1, 2015 and ending on September 1, 2016.
2. The undersigned and all related parties owned ten or fewer mining claims, mill, or tunnel sites located and maintained on Federal lands in the United States of America on September 1, 2015.
3. The undersigned have performed the assessment work required by law for each mining claim listed prior to filing this waiver and understand that by filing this form, the undersigned must file an affidavit of assessment work with the Bureau of Land Management (BLM) by the December 30th following the filing of this waiver.
4. The undersigned understand that if the assessment work obligation has not yet come due under 30 U.S.C. 28 (for those claims in their first assessment year only), a notice of intent to hold reciting this condition must be recorded by the December 30th following the filing of this waiver.
5. The undersigned understand that mill and tunnel sites may also be listed on this waiver and be waived from payment of the maintenance fee, and that a notice of intent to hold for these sites is required to be filed with the BLM by the December 30th following the filing of this waiver.
6. The undersigned understand and acknowledge that pursuant to 43 U.S.C. 1212 and 18 U.S.C. 1001, the filing or recording of a false, fictitious, or fraudulent document with the BLM may result in a fine of up to \$250,000, a prison term not to exceed five years, or both.
7. The mining claims, mill or tunnel sites for which this waiver from payment of the maintenance fees is requested are:

CLAIM OR SITE NAME	BLM RECORDATION SERIAL NUMBER
1. <u>MPCD 3</u>	<u>AMC 417461</u> ✓
2. <u>MPCD 2</u>	<u>AMC 412576</u>
3. <u>MPCD 1</u>	<u>AMC 412575</u>
4. <u>BIG BEND</u>	<u>AMC 381462</u>
5.	
6.	
7.	
8.	
9.	
10.	

RECEIVED  
BLM AZ STATE OFFICE  
2015 AUG - 6 P 3:03  
PHOENIX, ARIZONA

The owner(s) (claimants) of the above mining claims and sites are:

PRESTON PIEPER  
(Owner's Name - Please Print)  
200 HIGH CHAPARRAL  
(Owner's Mailing Address)

*[Signature]*  
(Owner's Signature)  
PRESCOTT AZ 86303  
(City) (State) (Zip Code)

MARILYN PIEPER  
(Owner's Name - Please Print)  
200 HIGH CHAPARRAL  
(Owner's Mailing Address)

*[Signature]*  
(Owner's Signature)  
PRESCOTT AZ 86303  
(City) (State) (Zip Code)

\_\_\_\_\_  
(Owner's Name - Please Print)  
\_\_\_\_\_  
(Owner's Mailing Address)

\_\_\_\_\_  
(Owner's Signature)  
\_\_\_\_\_  
(City) (State) (Zip Code)

\_\_\_\_\_  
(Owner's Name - Please Print)  
\_\_\_\_\_  
(Owner's Mailing Address)

\_\_\_\_\_  
(Owner's Signature)  
\_\_\_\_\_  
(City) (State) (Zip Code)

(Continued on page 2)

ENTERED  
SEP 02 2015  
BY: *[Signature]*

NW ✓  
9/2/2015  
*[Signature]*

(Owner's Name - Please Print)

(Owner's Signature)

(Owner's Mailing Address)

(City)

(State)

(Zip Code)

(Owner's Name - Please Print)

(Owner's Signature)

(Owner's Mailing Address)

(City)

(State)

(Zip Code)

(Owner's Name - Please Print)

(Owner's Signature)

(Owner's Mailing Address)

(City)

(State)

(Zip Code)

(Owner's Name - Please Print)

(Owner's Signature)

(Owner's Mailing Address)

(City)

(State)

(Zip Code)

18 U.S.C. 1001 and 43 U.S.C. 1212 make it a crime for any person knowingly and willfully to make to any department or agency of the United States any false, fictitious or fraudulent statements or representations as to any matter within its jurisdiction.

#### INSTRUCTIONS

1. This certification is made under the provisions of 43 U.S.C. § 1744 and 30 U.S.C. §28-28k and the regulations thereunder (43 CFR Part 3830).
2. The claimant(s) must fill in the dates in paragraph 1 for the beginning and ending of the assessment year for which this waiver is sought.
3. The claimant(s) must fill in the date in paragraph 2 for the beginning of the assessment year for which this waiver is sought.
4. All claim and site names and BLM serial numbers must be listed for the mining claims, mill sites, and tunnel sites for which the waiver is sought.
5. All owners of the mining claims, mill sites, and tunnel sites and their addresses must be given.
6. This waiver form must be signed by all the claimants or their designated agent, in original form. If an agent is designated, a notarized designation of agent, signed by all of the claimants with proper address given, must be submitted with this waiver.
7. This form must be filed no later than September 1st for the upcoming assessment year in the BLM State Office where the mining claims or sites are recorded, or the waiver cannot be granted by the BLM. (Example: To obtain a waiver for the assessment year 2012, which begins on September 1, 2011, you must qualify for and file for a waiver no later than September 1, 2011, in the proper BLM State Office.)
8. For all mining claims which require assessment work, you must record an affidavit of labor on or before the December 30th immediately following the filing of this waiver. For all other mining claims or sites waived, you must record a notice of intent to hold on or before the December 30th immediately following the filing of this waiver.
9. Mill and tunnel sites may also be listed on this waiver and be waived from payment of the maintenance fee. A notice of intent to hold for these sites is required to be filed by the December 30th following the filing of this waiver.

RECEIVED  
BLM AZ STATE OFFICE  
2015 AUG -6 P 3:04  
PHOENIX, ARIZONA

FOR OFFICIAL USE ONLY



UNITED STATES  
DEPARTMENT OF THE INTERIOR  
BUREAU OF LAND MANAGEMENT

000001 000002 000003 000004 000005 000006 000007 000008 000009 000010 000011 000012 000013 000014 000015 000016 000017 000018 000019 000020 000021 000022 000023 000024 000025 000026 000027 000028 000029 000030 000031 000032 000033 000034 000035 000036 000037 000038 000039 000040 000041 000042 000043 000044 000045 000046 000047 000048 000049 000050 000051 000052 000053 000054 000055 000056 000057 000058 000059 000060 000061 000062 000063 000064 000065 000066 000067 000068 000069 000070 000071 000072 000073 000074 000075 000076 000077 000078 000079 000080 000081 000082 000083 000084 000085 000086 000087 000088 000089 000090 000091 000092 000093 000094 000095 000096 000097 000098 000099 000100 000101 000102 000103 000104 000105 000106 000107 000108 000109 000110 000111 000112 000113 000114 000115 000116 000117 000118 000119 000120 000121 000122 000123 000124 000125 000126 000127 000128 000129 000130 000131 000132 000133 000134 000135 000136 000137 000138 000139 000140 000141 000142 000143 000144 000145 000146 000147 000148 000149 000150 000151 000152 000153 000154 000155 000156 000157 000158 000159 000160 000161 000162 000163 000164 000165 000166 000167 000168 000169 000170 000171 000172 000173 000174 000175 000176 000177 000178 000179 000180 000181 000182 000183 000184 000185 000186 000187 000188 000189 000190 000191 000192 000193 000194 000195 000196 000197 000198 000199 000200 000201 000202 000203 000204 000205 000206 000207 000208 000209 000210 000211 000212 000213 000214 000215 000216 000217 000218 000219 000220 000221 000222 000223 000224 000225 000226 000227 000228 000229 000230 000231 000232 000233 000234 000235 000236 000237 000238 000239 000240 000241 000242 000243 000244 000245 000246 000247 000248 000249 000250 000251 000252 000253 000254 000255 000256 000257 000258 000259 000260 000261 000262 000263 000264 000265 000266 000267 000268 000269 000270 000271 000272 000273 000274 000275 000276 000277 000278 000279 000280 000281 000282 000283 000284 000285 000286 000287 000288 000289 000290 000291 000292 000293 000294 000295 000296 000297 000298 000299 000300 000301 000302 000303 000304 000305 000306 000307 000308 000309 000310 000311 000312 000313 000314 000315 000316 000317 000318 000319 000320 000321 000322 000323 000324 000325 000326 000327 000328 000329 000330 000331 000332 000333 000334 000335 000336 000337 000338 000339 000340 000341 000342 000343 000344 000345 000346 000347 000348 000349 000350 000351 000352 000353 000354 000355 000356 000357 000358 000359 000360 000361 000362 000363 000364 000365 000366 000367 000368 000369 000370 000371 000372 000373 000374 000375 000376 000377 000378 000379 000380 000381 000382 000383 000384 000385 000386 000387 000388 000389 000390 000391 000392 000393 000394 000395 000396 000397 000398 000399 000400 000401 000402 000403 000404 000405 000406 000407 000408 000409 000410 000411 000412 000413 000414 000415 000416 000417 000418 000419 000420 000421 000422 000423 000424 000425 000426 000427 000428 000429 000430 000431 000432 000433 000434 000435 000436 000437 000438 000439 000440 000441 000442 000443 000444 000445 000446 000447 000448 000449 000450 000451 000452 000453 000454 000455 000456 000457 000458 000459 000460 000461 000462 000463 000464 000465 000466 000467 000468 000469 000470 000471 000472 000473 000474 000475 000476 000477 000478 000479 000480 000481 000482 000483 000484 000485 000486 000487 000488 000489 000490 000491 000492 000493 000494 000495 000496 000497 000498 000499 000500 000501 000502 000503 000504 000505 000506 000507 000508 000509 000510 000511 000512 000513 000514 000515 000516 000517 000518 000519 000520 000521 000522 000523 000524 000525 000526 000527 000528 000529 000530 000531 000532 000533 000534 000535 000536 000537 000538 000539 000540 000541 000542 000543 000544 000545 000546 000547 000548 000549 000550 000551 000552 000553 000554 000555 000556 000557 000558 000559 000560 000561 000562 000563 000564 000565 000566 000567 000568 000569 000570 000571 000572 000573 000574 000575 000576 000577 000578 000579 000580 000581 000582 000583 000584 000585

**Expires: October 31, 2016**

417461

# 3361318

2. Type of labor and improvements (specify what was done and give the total value for that labor and improvement to show at least \$100 for each claim). If a geological, geochemical, or geophysical survey was performed, as per 30 U.S.C. 28-1, reference the title of the report of survey, give cost and date of the survey and report, and indicate it was filed with the County Recorder:

Description of Work Performed			
Road Repairs, Active Mining	(MPCD 1)	\$ 150 -	2-27-15 / 5-18-15
Road Repairs "	(MPCD 2)	\$ 150 -	2-27-15 / 5-18-15
Road Repairs "	(MPCD 3)	\$ 150 -	2-27-15 / 5-18-15
Repaired claim signs / markers	MPCD 1-3	\$ 100 -	9-10-14
Road Repairs MPCD 1-3-		\$ 100 -	1-15

3. Name and mailing address of each person who performed the labor and improvements:

Name (please print)

PRESTON PIEPER  
JAMES RIDEN HOUR  
BILL COFFE

Current Mailing Address (please print)

200 HIGH CHAPARRAL PRESCOTT AZ 86303  
700 W. CHEROKEE PRESCOTT AZ 86303  
824 E. PINE KNOLL PRESCOTT AZ 86303

4. Name and mailing address of each person who holds and claims the subject mining claim(s) for the valuable minerals contained therein. Be sure to indicate if there is a change of address:

Name (please print)

PRESTON PIEPER  
MARILYN PIEPER

Current Mailing Address (please print)

200 HIGH CHAPARRAL PRESCOTT AZ 86303  
200 HIGH CHAPARRAL PRESCOTT AZ 86303

RECEIVED  
CLERK OF SUPERIOR COURT  
2015 AUG - 6 P 3:04  
PHOENIX, ARIZONA

5. The undersigned testifies that on the date of 7-24, 2015, all monuments required by law were erected upon the subject claim(s), and all notices required by law were posted on the subject claim(s) or copies thereof were in place, and at said date, each corner monument bore or contained

markings sufficient to appropriately designate the corner of the claim to which it pertains and the name of the claim(s).

I hereby certify under penalty of perjury under the laws of the State of ARIZONA that the foregoing statements are true and correct:

[Signature]  
(Signature of person responsible for above statement)

Date:

7-24-15

Title 18 U.S.C. 1601 and 43 U.S.C. 1212 make it a crime for any person knowingly and willfully to make to any department or agency of the United States any false, fictitious or fraudulent statements or representations as to any matter within its jurisdiction.

### Notary Block

SUBSCRIBED AND SWORN TO before me, this 24 day of July 20 15

By:

Beatrice Monter  
(Signature of Affiant)

Title:

Notary

My Commission Expires:

01/31/2018



### INSTRUCTIONS

1. This is an optional form that may be used to satisfy the requirements for the Bureau of Land Management (BLM) under the provisions of 43 U.S.C. §1744 and 30 U.S.C. §28-28d and the regulations thereunder (43 CFR part 3835). Since local and State laws may vary, you should contact your local and State agencies where the claims are located to ensure all applicable laws and requirements are satisfied.
2. The claimant(s) must fill in the date in paragraph 1 for the applicable assessment year and the county and state where the claims are located.
3. All claim names, BLM serial numbers, legal descriptions, and original county recording information must be listed for the claims pertaining to this assessment notice.
4. The claimant(s) must complete paragraph 2 listing all labor or improvements which was performed on or did benefit the subject mining claims. The value and date of the labor or improvements must also be listed. The total amount of labor or improvements can be listed, but the total expenditure must equal at least \$100 for each claim.
5. The names and current mailing addresses of the person(s) performing the labor shall be listed in paragraph 3.
6. The name and current mailing address of each owner (claimant) of the claims shall be listed in paragraph 4. The mailing address shall be the owner's address and not the address of an agent or anyone representing the claimant. Be sure to note if there has been a change of address.
7. Paragraph 5 shall be completed to show the date it was verified that all monuments required by law were properly erected, all notices were posted, and that corners were appropriately designated for all claims listed.
8. An exact legible reproduction or duplicate (other than microfilm or other electronic media) of this affidavit or another type of affidavit of assessment work that you file or will file in the county where each claim is located, must be filed with the BLM on or before December 30 of the calendar year in which the assessment year ends. For mill or tunnel sites, a separate notice of intent to hold must be filed with the BLM on or before December 30. Requirements for filing a notice of intent to hold can be found at 43 CFR 3835.33.
9. A processing fee of \$10 for each claim listed must be remitted to the BLM along with this or any other affidavit of assessment work.



Preston & Marilyn Pieper  
200 High Chaparral Loop  
Prescott, AZ 86303

RECEIVED  
BLM AZ STATE OFFICE

2015 AUG -6 P 2:45

PHOENIX, ARIZONA

BLM  
ARIZONA STATE OFFICE  
ONE NORTH CENTRAL AVE. Suite 800  
PHOENIX, AZ 85004-4427

PHOENIX AZ 852  
04 AUG 2015 PM 5 L

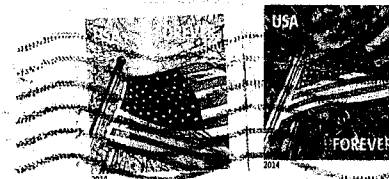

85004442700

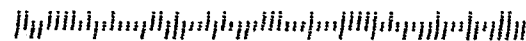

Preston & Marilyn Pieper  
200 High Chaparral Loop  
Prescott, AZ 86303

RECEIVED  
BLM AZ STATE OFFICE

2015 AUG -6 P 2:45

PHOENIX, ARIZONA

BLM  
ARIZONA STATE OFFICE  
ONE NORTH CENTRAL AVE. SUITE 800  
PHOENIX, AZ 85004-4427

85004442700

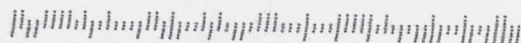

PHOENIX, AZ 852  
04 AUG 2015 PM 5 L



**United States Department of the Interior**  
**Bureau of Land Management**  
LANDS/RECREATION & PLANNING  
ONE N CENTRAL AVE  
PHOENIX, AZ 85004 -2203  
Phone: 602-417-9200

Receipt

No: 3361318

<b>Transaction #:</b> 3459315	
<b>Date of Transaction:</b> 08/07/2015	
<b>CUSTOMER:</b>	
	MARILYN PIEPER 200 HIGH CHAPARRAL PRESCOTT, AZ 86303-6356 US

LINE #	QTY	DESCRIPTION	REMARKS	UNIT PRICE	TOTAL
1	1.00	LOCATABLE MINERALS / MINING CLAIMS- NOT NEW-UNADJUD, ONE AUTH NO. ONLY / MINING CLAIM MONEY RECEIVED <b>CASES:</b> AMC412575/\$50.00	POL 2015/3 WAV TRF/2	- n/a -	50.00
<b>TOTAL:</b>					<b>\$50.00</b>

PAYMENT INFORMATION				
1	AMOUNT:	50.00	POSTMARKED:	08/04/2015
	TYPE:	CHECK	RECEIVED:	08/06/2015
	CHECK NO:	2494		
	NAME:	PIEPER, PRESTON L 200 HIGH CHAPARRAL PRESCOTT AZ 86303-6356 US		

REMARKS

This receipt was generated by the automated BLM Collections and Billing System and is a paper representation of a portion of the official electronic record contained therein.

*RIAN*

102

Amc 412575

417461

Form 3830-2  
(October 2013)UNITED STATES  
DEPARTMENT OF THE INTERIOR  
BUREAU OF LAND MANAGEMENT

## MAINTENANCE FEE WAIVER CERTIFICATION

SEE INSTRUCTIONS ON PAGE 2

FORM APPROVED  
OMB NO. 1004-0114  
Expires: October 31, 2016

1. This small miner waiver is filed for the assessment year beginning on September 1, 2014 and ending on September 1, 2015.
2. The undersigned and all related parties owned ten or fewer mining claims, mill, or tunnel sites located and maintained on Federal lands in the United States of America on September 1, 2014.
3. The undersigned have performed the assessment work required by law for each mining claim listed prior to filing this waiver and understand that by filing this form, the undersigned must file an affidavit of assessment work with the Bureau of Land Management (BLM) by the December 30th following the filing of this waiver.
4. The undersigned understand that if the assessment work obligation has not yet come due under 30 U.S.C. 28 (for those claims in their first assessment year only), a notice of intent to hold reciting this condition must be recorded by the December 30th following the filing of this waiver.
5. The undersigned understand that mill and tunnel sites may also be listed on this waiver and be waived from payment of the maintenance fee, and that a notice of intent to hold for these sites is required to be filed with the BLM by the December 30th following the filing of this waiver.
6. The undersigned understand and acknowledge that pursuant to 43 U.S.C. 1212 and 18 U.S.C. 1001, the filing or recording of a false, fictitious, or fraudulent document with the BLM may result in a fine of up to \$250,000, a prison term not to exceed five years, or both.
7. The mining claims, mill or tunnel sites for which this waiver from payment of the maintenance fees is requested are:

CLAIM OR SITE NAME	BLM RECORDATION SERIAL NUMBER
1. MPCD 1	AMC 412575 ✓
2. MPCD 2	AMC 412576
3. MPCD 3	AMC 417461
4.	
5.	
6.	
7.	
8.	
9.	
10.	

RECEIVED  
BLM AZ STATE OFFICE  
2014 JUL 28 PM 3:58  
PHOENIX, ARIZONA

The owner(s) (claimants) of the above mining claims and sites are:

Preston Pieper

(Owner's Name - Please Print)

200 High Chaparral ✓

(Owner's Mailing Address)

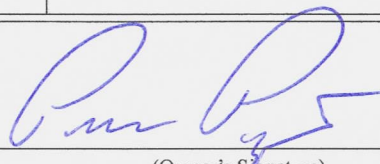

(Owner's Signature)

Prescott

(City)

az

(State)

86303

(Zip Code)

Marilyn Pieper

(Owner's Name - Please Print)

200 High Chaparral ✓

(Owner's Mailing Address)

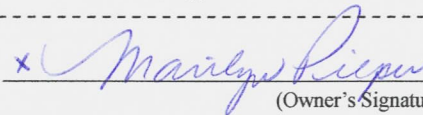

(Owner's Signature)

Prescott

(City)

az

(State)

86303

(Zip Code)

(Owner's Name - Please Print)

(Owner's Mailing Address)

(Owner's Signature)

(City)

(State)

(Zip Code)

(Owner's Name - Please Print)

(Owner's Mailing Address)

(Owner's Signature)

(City)

(State)

(Zip Code)

(Continued on page 2)

NW CHECKED SEP 22 2014

PB

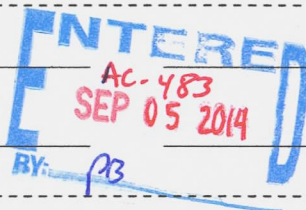



\_\_\_\_\_  
(Owner's Name - Please Print)

\_\_\_\_\_  
(Owner's Signature)

\_\_\_\_\_  
(Owner's Mailing Address)

\_\_\_\_\_  
(City)

\_\_\_\_\_  
(State)

\_\_\_\_\_  
(Zip Code)

-----  
\_\_\_\_\_  
(Owner's Name - Please Print)

\_\_\_\_\_  
(Owner's Signature)

\_\_\_\_\_  
(Owner's Mailing Address)

\_\_\_\_\_  
(City)

\_\_\_\_\_  
(State)

\_\_\_\_\_  
(Zip Code)

-----  
\_\_\_\_\_  
(Owner's Name - Please Print)

\_\_\_\_\_  
(Owner's Signature)

\_\_\_\_\_  
(Owner's Mailing Address)

\_\_\_\_\_  
(City)

\_\_\_\_\_  
(State)

\_\_\_\_\_  
(Zip Code)

-----  
\_\_\_\_\_  
(Owner's Name - Please Print)

\_\_\_\_\_  
(Owner's Signature)

\_\_\_\_\_  
(Owner's Mailing Address)

\_\_\_\_\_  
(City)

\_\_\_\_\_  
(State)

\_\_\_\_\_  
(Zip Code)

18 U.S.C. 1001 and 43 U.S.C. 1212 make it a crime for any person knowingly and willfully to make to any department or agency of the United States any false, fictitious or fraudulent statements or representations as to any matter within its jurisdiction.

#### INSTRUCTIONS

1. This certification is made under the provisions of 43 U.S.C. § 1744 and 30 U.S.C. §28-28k and the regulations thereunder (43 CFR Part 3830).
2. The claimant(s) must fill in the dates in paragraph 1 for the beginning and ending of the assessment year for which this waiver is sought.
3. The claimant(s) must fill in the date in paragraph 2 for the beginning of the assessment year for which this waiver is sought.
4. All claim and site names and BLM serial numbers must be listed for the mining claims, mill sites, and tunnel sites for which the waiver is sought.
5. All owners of the mining claims, mill sites, and tunnel sites and their addresses must be given.
6. This waiver form must be signed by all the claimants or their designated agent, in original form. If an agent is designated, a notarized designation of agent, signed by all of the claimants with proper address given, must be submitted with this waiver.
7. This form must be filed no later than September 1st for the upcoming assessment year in the BLM State Office where the mining claims or sites are recorded, or the waiver cannot be granted by the BLM. (Example: To obtain a waiver for the assessment year 2012, which begins on September 1, 2011, you must qualify for and file for a waiver no later than September 1, 2011, in the proper BLM State Office.)
8. For all mining claims which require assessment work, you must record an affidavit of labor on or before the December 30th immediately following the filing of this waiver. For all other mining claims or sites waived, you must record a notice of intent to hold on or before the December 30th immediately following the filing of this waiver.
9. Mill and tunnel sites may also be listed on this waiver and be waived from payment of the maintenance fee. A notice of intent to hold for these sites is required to be filed by the December 30th following the filing of this waiver.

\_\_\_\_\_  
FOR OFFICIAL USE ONLY



When Recorded Return Document to:

PRESTON PIEPER  
200 HIGH CHAPARRAL  
PRESCOTT, AZ 86303



AMC 412575  
417461

☐ Check here if this is a change of address.

Telephone: 928-771-1782

E-mail address: \_\_\_\_\_

### AFFIDAVIT OF PERFORMANCE OF ANNUAL WORK

1. State of Arizona, County of YAVAPAI ss:

2. I (Name) PRESTON PIEPER

3. Reside at (Address) 200 HIGH CHAPARRAL

City PRESCOTT County YAVAPAI

State AZ Zip 86303 being duly sworn, depose and say that I am a citizen of the United States, more than eighteen years of age, and that all of the facts set forth in this affidavit, subject to the provisions and penalties of 18 U.S.C. 1001 pertaining to the filing of false, fictitious, or fraudulent statements with the United States, are true and correct according to the best of my knowledge, information and belief.

4. Owner's name and address (If not shown in Items 1-3 above). MARILYN PIEPER  
200 HIGH CHAPARRAL PRESCOTT, AZ 86303

5. That I am personally acquainted with the mining claim(s). The work and improvements were made by and at the expense of the owner(s) of said claim(s). Said contiguous group of claims, listed on this document, are situated in the

BLACK CANYON (optional) Mining District; YAVAPAI County, Arizona.

Line No.	AMC NUMBER	CLAIM/SITE NAME	COUNTY RECORDER DATA (If available)	TWP	RNG	SEC
1	412575	MPCD 1		10N	2E	31
2	412576	MPCD 2		10N	2E	32
3	417461	MPCD 3		10N	2E	31
4						
5						
6						

Form: MCF108  
Revised Jan. 2006  
Page 1 of 2

ENTERED  
JUL 31 2014

BY: ARM

2014 JUL 28 PM 3:58  
 PHOENIX, ARIZONA  
 RECEIVED  
 BLM AZ STATE OFFICE  
 BLM  
 Date  
 Stamp

7						
8						
9						
10						

6. That between the dates starting at 12 o'clock noon on September 1, 20 13 and ending at 12 o'clock noon on September 1, 20 14 at least \$ 600.00 dollars worth of work and improvements were done and performed upon said claim(s) or upon one or more of a contiguous group of claims for the benefit of all, wholly or partly outside of a contiguous group of claims for the benefit of all, not including the location work.

7. That the following persons were employed to perform the work and improvements described herein: PRESTON PIEPER, DAVID RIDENHOUR

8. That the work and improvements performed were: ROAD WORK, SAMPLING, MEDAL DETECTING, ACTIVE MINING, DISCOVERY WORK.

9. Dated: 7-17-2014 Signature: [Signature]

SUBSCRIBED AND SWORN TO before me, a Notary Public, this 17 day of July 20 14

By: PRESTON L. PIEPER

Notary Public Rhonda Hicks

My Commission Expires 3/19/2016

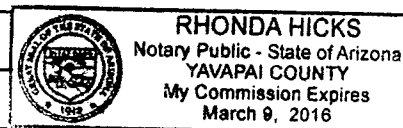

Bureau of Land Management  
 Arizona State Office  
[www.az.blm.gov](http://www.az.blm.gov)

No. of Claims: 3 x \$10 = \$30.00  
 Check No.: 2459 Init. CHH  
 Receipt No.: 3087337  
 For BLM Use Only

Preston & Marilyn Pieper  
200 High Chaparral Loop  
Prescott, AZ 86303

RECEIVED  
BLM AZ STATE OFFICE

PHOENIX AZ 852  
26 JUL 2014 PM 10 L



2014 JUL 28 PM 3:17

PHOENIX, ARIZONA

BUREAU OF LAND MANAGEMENT  
ARIZONA STATE OFFICE  
ONE NORTH CENTRAL AVENUE, SUITE 800  
PHOENIX, AZ 85004-4427

85004442700

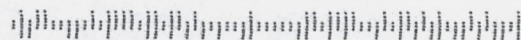

Preston & Marilyn Pieper  
200 High Chaparral Loop  
Prescott, AZ 86303

RECEIVED  
BLM AZ STATE OFFICE

PHOENIX, AZ 852  
26 JUL 2014 PM 10 L



2014 JUL 28 PM 3:17

PHOENIX, ARIZONA

BUREAU OF LAND MANAGEMENT  
ARIZONA STATE OFFICE  
ONE NORTH CENTRAL AVENUE, SUITE 800  
PHOENIX, AZ 85004-4427

85004442700

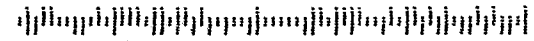

United States Department of the Interior  
 Bureau of Land Management  
 LANDS/RECREATION & PLANNING  
 ONE N CENTRAL AVE  
 PHOENIX, AZ 85004 -2203  
 Phone: 602-417-9200



Receipt

No:

3087337

<b>Transaction #:</b> 3178692	
<b>Date of Transaction:</b> 07/29/2014	
<b>CUSTOMER:</b>	
	PRESTON PIEPER 200 HIGH CHAPARRAL PRESCOTT, AZ 86303-6356 US

LINE #	QTY	DESCRIPTION	REMARKS	UNIT PRICE	TOTAL
1	1.00	LOCATABLE MINERALS / MINING CLAIMS-NOT NEW-UNADJUD, ONE AUTH NO. ONLY / MINING CLAIM MONEY RECEIVED <b>CASES:</b> AMC412575/\$30.00	MAINT FEE WAIVER (3) 2015 / POL (3) 2014 ✓	- n/a -	30.00
<b>TOTAL:</b>					<b>\$30.00</b>

PAYMENT INFORMATION			
1	AMOUNT:	30.00	POSTMARKED: 07/26/2014
	TYPE:	CHECK	RECEIVED: 07/28/2014
	CHECK NO:	2459	
	NAME:	PIEPER, MARILYN F 200 HIGH CHAPARRAL PRESCOTT AZ 86303-6356 US	

REMARKS

This receipt was generated by the automated BLM Collections and Billing System and is a paper representation of a portion of the official electronic record contained therein.



UNITED STATES  
DEPARTMENT OF THE INTERIOR  
BUREAU OF LAND MANAGEMENT

MAINTENANCE FEE WAIVER CERTIFICATION

AdH

200 Amc 417461  
FORM APPROVED  
OMB NO. 1004-0114  
Expires: August 31, 2013

Amc 412575

SEE INSTRUCTIONS ON PAGE 2

1. This small miner waiver is filed for the assessment year beginning on September 1, 2013 and ending on September 1, 2014.
2. The undersigned and all related parties owned ten or fewer mining claims, mill, or tunnel sites located and maintained on Federal lands in the United States of America on September 1, 2013.
3. The undersigned have performed the assessment work required by law for each mining claim listed prior to filing this waiver and understand that by filing this form, an affidavit of assessment work must be recorded by the December 30th following the filing of this waiver.
4. The undersigned understand that if the assessment work obligation has not yet come due under 30 U.S.C. 28 (for those claims in their first assessment year only), a notice of intent to hold reciting this condition must be recorded by the December 30th following the filing of this waiver.
5. The undersigned understand that mill and tunnel sites may also be listed upon this waiver and be waived from payment of the maintenance fee, and that a notice of intent to hold for these sites is required to be recorded by the December 30th immediately following the filing of this waiver.
6. The undersigned understand and acknowledge that pursuant to 43 U.S.C. 1212 and 18 U.S.C. 1001, the filing or recording of a false, fictitious, or fraudulent document with the Bureau of Land Management may result in a fine of up to \$250,000, a prison term not to exceed five years, or both.
7. The mining claims, mill or tunnel sites for which this waiver from payment of the maintenance fees is requested are:

CLAIM OR SITE NAME	BLM RECORDATION SERIAL NUMBER
1. <u>MPCD3</u>	<u>Amc 417461</u>
2. <u>MPCD2</u>	<u>Amc 412576</u>
3. <u>MPCD1</u>	<u>Amc 412575</u>
4.	
5.	
6.	
7.	
8.	
9.	
10.	

The owner(s) (claimants) of the above mining claims and sites are:

PRESTON PIEPER ✓  
(Owner's Name - Please Print)

[Signature]  
(Owner's Signature)

200 HIGH CHAPARRAL  
(Street or P.O. Box)

PRESCOTT AZ 86303  
(City) (State) (Zip Code)

MARILYN PIEPER ✓  
(Owner's Name - Please Print)

[Signature]  
(Owner's Signature)

200 HIGH CHAPARRAL  
(Street or P.O. Box)

PRESCOTT AZ 86303  
(City) (State) (Zip Code)

RECEIVED  
BLM AT STATE OFFICE  
PHOENIX, ARIZONA  
2013 AUG -8 PM 2:43

\_\_\_\_\_  
(Owner's Name - Please Print)

\_\_\_\_\_  
(Owner's Signature)

\_\_\_\_\_  
(Street or P.O. Box)

\_\_\_\_\_  
(City) (State) (Zip Code)

ENTERED INTO COMPUTER  
SEP 17 2013 PB

When Recorded Return Document:

PRESTON PIEPER  
200 High Chaparral  
PRESCOTT, AZ 86303

B: 4974 P: 77

2013-0045424

Leslie M. Hof

OFFICIAL RECORDS

PRESTON PIEPER

08/07/2013 10:20:42 AM

Page: 1 of 2

ADL

OFFICIAL RECORDS OF YAVAPAI COUNTY \$15.00

☐ Check here if this is a change of address.

Telephone: 928-771-1782

E-mail address: \_\_\_\_\_

Preston & Marilyn Pieper  
200 High Chaparral Loop  
Prescott, AZ 86303

### AFFIDAVIT OF PERFORMANCE OF ANNUAL WORK

1. State of Arizona, County of YAVAPAI ss:

2. I (Name) PRESTON PIEPER

3. Reside at (Address) 200 High Chaparral

City PRESCOTT County YAVAPAI

State AZ Zip 86303 being duly sworn, depose and say that I am a citizen of the United States, more than eighteen years of age, and that all of the facts set forth in this affidavit, subject to the provisions and penalties of 18 U.S.C. 1001 pertaining to the filing of false, fictitious, or fraudulent statements with the United States, are true and correct according to the best of my knowledge, information and belief.

4. Owner's name and address (If not shown in Items 1-3 above). MARILYN PIEPER  
200 High Chaparral Prescott, AZ 86303

5. That I am personally acquainted with the mining claim(s). The work and improvements were made by and at the expense of the owner(s) of said claim(s). Said contiguous group of claims, listed on this document, are situated in the

Black Canyon (optional) Mining District; YAVAPAI County, Arizona.

Line No.	AMC NUMBER	CLAIM/SITE NAME	COUNTY RECORDER DATA (If available)	TWP	RNG	SEC
1	<u>Amc 412575</u>	<u>MPCD 1</u>		<u>10N</u>	<u>2E</u>	<u>31</u>
2	<u>Amc 412576</u>	<u>MPCD 2</u>		<u>10N</u>	<u>2E</u>	<u>32</u>
3	<u>Amc 417461</u>	<u>MPCD 3</u>		<u>10N</u>	<u>2E</u>	<u>31</u>
4						
5						
6						

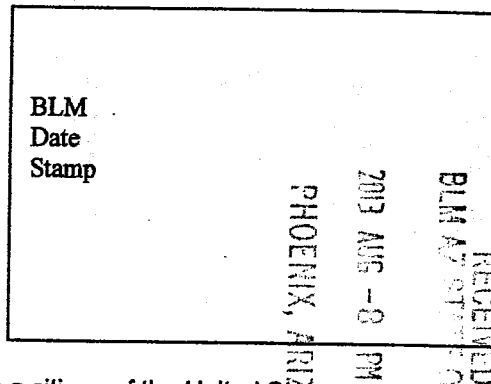

Form: MCF108

Revised Jan. 2006

Page 1 of 2

ENTERED  
SEP 01 2013  
BY: AT

BLM  
Date  
Stamp

2013 AUG -8 PM 2:53  
PHOENIX, ARIZONA

RECEIVED  
BLM AZ STATE OFFICE

7						
8						
9						
10						

6. That between the dates starting at 12 o'clock noon on September 1, 20 12 and ending at 12 o'clock noon on September 1, 20 13 at least \$ 360.00 dollars worth of work and improvements were done and performed upon said claim(s) or upon one or more of a contiguous group of claims for the benefit of all, wholly or partly outside of a contiguous group of claims for the benefit of all, not including the location work.

7. That the following persons were employed to perform the work and improvements described herein: PRESTON PIEPER, MARILYN PIEPER, PAUL RIBENHOOD

8. That the work and improvements performed were: ROAD WORK, ACTIVE MINING, CLEAN TRAIL OF DEBRIS

9. Dated: 8-6-13 Signature: [Signature]

SUBSCRIBED AND SWORN TO before me, a Notary Public, this 6th day of August 20 13

By: Preston Pieper

Notary Public Meredith Dunlap

My Commission Expires 12-30-2016

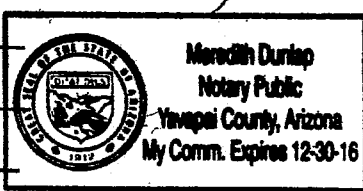

Bureau of Land Management  
Arizona State Office  
[www.az.blm.gov](http://www.az.blm.gov)

No. of Claims: 3 x \$10 = \$30.00  
Check No.: 2405 Init. [Initials]  
Receipt No.: 2851181  
For BLM Use Only

Preston & Marilyn Pieper  
200 High Chaparral Loop  
Prescott, AZ 86303

**NOTICE OF INTENTION TO HOLD MINING CLAIMS/SITES**

When Recorded Return Document to:

PRESTON PIEPER  
200 HIGH CHAPARRAL  
PRESOTT, AZ 86303

BLM  
Date  
Stamp

2013 AUG -8 PM 2:54  
PHOENIX, ARIZONA

RECEIVED  
BLM AZ STATE OFFICE

☐ Check here if this is a change of address.
Telephone: 928 771-1782

E-mail Address \_\_\_\_\_

I (We) intend to hold the claims(s) and/or site(s) listed below for the calendar year 20 14, and I (We) have filed or will file a Notice of Intent to Hold in the county where the claim (s) is located.

Reason for filing a Notice of Intent to Hold instead of an assessment work filing (check one):

☐ Maintenance fee was paid to maintain claim(s) during this assessment year.

☐ Mill or tunnel sites.

☒ Claim(s) was located during the current assessment year.

☐ BLM has deferred assessment work (attach copy of decision granting deferment, or pending petition for deferment including date petition was filed.)

Line No.	AMC NUMBER	CLAIM/SITE NAME	COUNTY RECORDER DATA (If available)	TWP	RNG	SEC
1	AMC 417461	MPCD 3		10N	2E	31
2						
3						
4						
5						
6						
7						
8						
9						
10						

ENTERED  
SEP 01 2013  
BY: AT

Form: MCF110

Revised Jan.2006

Page 1 of 2

NOTICE OF INTENTION TO HOLD MINING CLAIMS/SITES  
page 2

BLM Date Stamp	2013 AUG -0 PM 2:54 PHOENIX, ARIZONA	RECEIVED BLM AZ STATE OFFICE
----------------------	---	---------------------------------

1. State of Arizona, County of YAVAPAI
2. I (Name) PRESTON PIEPER
3. Reside at (Address) 200 HIGH CHAPARRAL  
City PRESCOTT County YAVAPAI State AZ Zip 86303 being duly sworn, depose and say that I am a citizen of the United States, more than eighteen years of age, that all of the facts set forth in this notice, subject to the provisions and penalties of 18 U.S.C. 1001 pertaining to the filing of false, fictitious, or fraudulent statements with the United States, are true and correct according to the best of my knowledge, information and belief.
4. Owner's name and address (If not shown in Items 1-3 above). MARILYN PIEPER  
200 HIGH CHAPARRAL, PRESCOTT, AZ 86303
5. Dated: 8-7-13 Signature: [Signature]

Bureau of Land Management  
Arizona State Office  
[www.az.blm.gov](http://www.az.blm.gov)

No. of Claims:	<u>1</u>	x \$10 =	<u>\$10.00</u>
Check No:	<u>2405</u>	Init.	<u>APL</u>
Receipt No.:	<u>2851181</u>		
For BLM Use Only			

Form: MCF110  
Revised Jan. 2006  
Page 2 of 2



Preston & Marilyn Pieper  
200 High Chaparral Loop  
Prescott, AZ 86303

RECEIVED  
BLM AZ STATE OFFICE

2013 AUG -8 PM 2:54

PHOENIX, ARIZONA



1000



85004

U.S. POSTAGE  
PAID  
PRESCOTT, AZ  
86301  
AUG 07, 13  
AMOUNT

\$0.46  
00061616-11

BUREAU OF LAND MANAGEMENT  
ARIZONA STATE OFFICE  
ONE NORTH CENTRAL AVENUE  
SUITE 800  
PHOENIX, AZ 85004-4427

85004442700

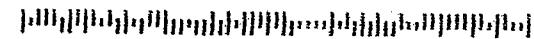

United States Department of the Interior  
Bureau of Land Management  
LANDS/RECREATION & PLANNING  
ONE N CENTRAL AVE  
PHOENIX, AZ 85004 -2203  
Phone: 602-417-9200

Receipt

No: 2851181

Transaction #: 2936913		<b>ENTERED INTO COMPUTER</b>
Date of Transaction: 08/09/2013		
CUSTOMER:		
PRESTON PIEPER 200 HIGH CHAPARRAL PRESCOTT, AZ 86303-6356 US		

LINE #	QTY	DESCRIPTION	REMARKS	UNIT PRICE	TOTAL
1	1.00	LOCATABLE MINERALS / MINING CLAIMS-NOT NEW-UNADJUD, ONE AUTH NO. ONLY / MINING CLAIM MONEY RECEIVED CASES: AMC417461/\$40.00	MAINT FEE WAIVER (3) 2014 / POL (3) 2013 / NOI (1) 2013	- n/a -	40.00
TOTAL:					\$40.00

PAYMENT INFORMATION			
1	AMOUNT:	40.00	POSTMARKED: 08/07/2013
	TYPE:	CHECK	RECEIVED: 08/08/2013
	CHECK NO:	2405	
	NAME:	PIEPER, MARILYN F 200 HIGH CHAPARRAL PRESCOTT AZ 86303-6356 US	

REMARKS

This receipt was generated by the automated BLM Collections and Billing System and is a paper representation of a portion of the official electronic record contained therein.

UNITED STATES  
DEPARTMENT OF THE INTERIOR  
BUREAU OF LAND MANAGEMENT

**MAINTENANCE FEE WAIVER CERTIFICATION**

*Jeff*

FORM APPROVED  
OMB NO. 1004-0114  
Expires: August 31, 2013

140

SEE INSTRUCTIONS ON PAGE 2

Amc 412575

1. This small miner waiver is filed for the assessment year beginning on September 1, 2012 and ending on September 1, 2013.
2. The undersigned and all related parties owned ten or fewer mining claims, mill, or tunnel sites located and maintained on Federal lands in the United States of America on September 1, 2012.
3. The undersigned have performed the assessment work required by law for each mining claim listed prior to filing this waiver and understand that by filing this form, an affidavit of assessment work must be recorded by the December 30th following the filing of this waiver.
4. The undersigned understand that if the assessment work obligation has not yet come due under 30 U.S.C. 28 (for those claims in their first assessment year only), a notice of intent to hold reciting this condition must be recorded by the December 30th following the filing of this waiver.
5. The undersigned understand that mill and tunnel sites may also be listed upon this waiver and be waived from payment of the maintenance fee, and that a notice of intent to hold for these sites is required to be recorded by the December 30th immediately following the filing of this waiver.
6. The undersigned understand and acknowledge that pursuant to 43 U.S.C. 1212 and 18 U.S.C. 1001, the filing or recording of a false, fictitious, or fraudulent document with the Bureau of Land Management may result in a fine of up to \$250,000, a prison term not to exceed five years, or both.
7. The mining claims, mill or tunnel sites for which this waiver from payment of the maintenance fees is requested are:

CLAIM OR SITE NAME	BLM RECORDATION SERIAL NUMBER
1. MPCD1	✓ AMC 412575
2. MPCD2	AMC 412576
3.	
4.	
5.	
6.	
7.	
8.	
9.	
10.	

The owner(s) (claimants) of the above mining claims and sites are:

PRESTON PIEPER ✓

(Owner's Name - Please Print)

200 HIGH CHAPARRAL

(Street or P.O. Box)

PRESCOTT

AZ

86303

(City)

(State)

(Zip Code)

MARILYN PIEPER ✓

(Owner's Name - Please Print)

200 HIGH CHAPARRAL

(Street or P.O. Box)

PRESCOTT

AZ

86303

(City)

(State)

(Zip Code)

(Owner's Name - Please Print)

(Street or P.O. Box)

(City)

(State)

(Zip Code)

(Continued on page 2)

*P. Pieper*  
(Owner's Signature)

*Marilyn Pieper*  
(Owner's Signature)

(Owner's Signature)

ENTERED INTO COMPUTER

8/28/12 AT

RECEIVED  
BLM AZ STATE OFFICE  
2012 AUG - 3 P 3:11  
PHOENIX, ARIZONA

When Recorded Return Document to:

PRESTON PIEPER  
200 HIGH CHAPARRAL  
PRESCOTT, AZ 86303

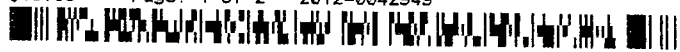

☐ Check here is this is a change of address.

Telephone: 928-771-1782

E-mail address: \_\_\_\_\_

**AFFIDAVIT OF PERFORMANCE OF ANNUAL WORK**

1. State of Arizona, County of YAVAPAI ss:

2. I (Name) PRESTON PIEPER

3. Reside at (Address) 200 High Chaparral

City PRESCOTT County YAVAPAI

BLM  
Date  
Stamp

RECEIVED  
BLM AZ STATE OFFICE  
2012 AUG -3 P 3:15  
PHOENIX, ARIZONA

State AZ Zip 86303 being duly sworn, depose and say that I am a citizen of the United States, more than eighteen years of age, and that all of the facts set forth in this affidavit, subject to the provisions and penalties of 18 U.S.C. 1001 pertaining to the filing of false, fictitious, or fraudulent statements with the United States, are true and correct according to the best of my knowledge, information and belief.

4. Owner's name and address (If not shown in Items 1-3 above). MARILYN PIEPER  
200 High Chaparral Prescott, AZ 86303

5. That I am personally acquainted with the mining claim(s). The work and improvements were made by and at the expense of the owner(s) of said claim(s). Said contiguous group of claims, listed on this document, are situated in the

Black Canyon (optional) Mining District; YAVAPAI County, Arizona.

Line No.	AMC NUMBER	CLAIM/SITE NAME	COUNTY RECORDER DATA (If available)	TWP	RNG	SEC
1	412575	MPCD 1		10N	2E	31
2	412576	MPCD 2		10N	2E	32
3						
4						
5						
6						

8/28/12 HT

AFFIDAVIT OF PERFORMANCE OF ANNUAL WORK - page 2

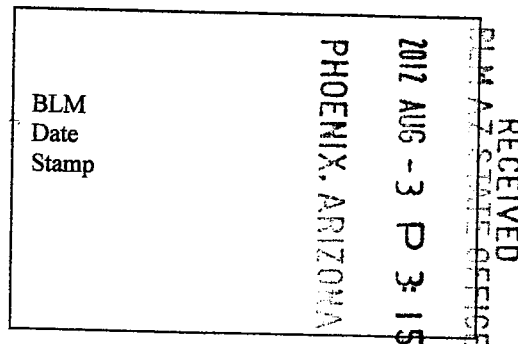

7						
8						
9						
10						

6. That between the dates starting at 12 o'clock noon on September 1, 20 11 and ending at 12 o'clock noon on September 1, 20 12 at least \$ 400.00 dollars worth of work and improvements were done and performed upon said claim(s) or upon one or more of a contiguous group of claims for the benefit of all, wholly or partly outside of a contiguous group of claims for the benefit of all, not including the location work.

7. That the following persons were employed to perform the work and improvements described herein: PRESTON PIEPER, MARILYN PIEPER, DAVID RIDENHOUR

8. That the work and improvements performed were: ROAD WORK, ACTIVE MINING, CLEAN TRAIL OF DEERIS

9. Dated: 8-2-2012 Signature: [Signature]

SUBSCRIBED AND SWORN TO before me, a Notary Public, this 2 day of August 20 12

By: Preston Pieper

Notary Public Jessica Bunnell

My Commission Expires April 30, 2016

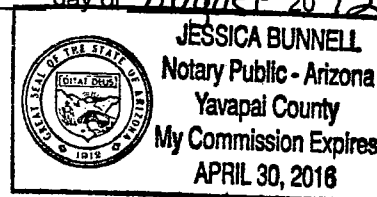

Bureau of Land Management  
Arizona State Office  
[www.az.blm.gov](http://www.az.blm.gov)

No. of Claims: 2 x \$10 = \$20.00  
Check No.: 2397 Init ACL  
Receipt No.: 2623745  
For BLM Use Only





**NOTICE OF INTENTION TO HOLD MINING CLAIMS/SITES**

When Recorded Return Document to:

PRESTON PIEPER  
200 HIGH CHAPARRAL  
PRESCOTT, AZ 86303

BLM  
Date  
Stamp

RECEIVED  
BLM AZ STATE OFFICE  
2012 AUG - 3 P 3:15  
PHOENIX, ARIZONA

☐ Check here if this is a change of address.

Telephone: 928 771-1782

E-mail Address \_\_\_\_\_

I (We) intend to hold the claims(s) and/or site(s) listed below for the calendar year 2013, and I (We) have filed or will file a Notice of Intent to Hold in the county where the claim (s) is located.

Reason for filing a Notice of Intent to Hold instead of an assessment work filing (check one):

- ☐ Maintenance fee was paid to maintain claim(s) during this assessment year.  
☐ Mill or tunnel sites.  
☒ Claim(s) was located during the current assessment year.  
☐ BLM has deferred assessment work (attach copy of decision granting deferment, or pending petition for deferment including date petition was filed.)

Line No.	AMC NUMBER	CLAIM/SITE NAME	COUNTY RECORDER DATA (If available)	TWP	RNG	SEC
1	412575	MPCD1		10N	2E	31
2	412576	MPCD2		10N	2E	32
3						
4						
5						
6						
7						
8						
9						
10						

Form: MCF110

Revised Jan.2006

Page 1 of 2

ENTRIED INTO COMPUTER

8/28/12 HT

NOTICE OF INTENTION TO HOLD MINING CLAIMS/SITES  
page 2

RECEIVED  
BLM AZ STATE OFFICE  
2012 AUG - 3 P 3:15  
PHOENIX, ARIZONA  
BLM  
Date  
Stamp

1. State of Arizona, County of YAVAPAI  
2. I (Name) PRESTON PIEPER / MARILYN PIEPER  
3. Reside at (Address) 200 HIGH CHAPARRAL  
City PRESCOTT County YAVAPAI State AZ Zip 86303 being duly sworn, depose and say that I am a citizen of the United States, more than eighteen years of age, that all of the facts set forth in this notice, subject to the provisions and penalties of 18 U.S.C. 1001 pertaining to the filing of false, fictitious, or fraudulent statements with the United States, are true and correct according to the best of my knowledge, information and belief.  
4. Owner's name and address (If not shown in Items 1-3 above).

5. Dated: 8-2-2012 Signature: Preston Pieper / Marilyn Pieper

Bureau of Land Management  
Arizona State Office  
[www.az.blm.gov](http://www.az.blm.gov)

No. of Claims: 2 x \$10 = \$20.00  
Check No: 2397 Init CH  
Receipt No.: 2623745  
For BLM Use Only

Form: MCF110  
Revised Jan. 2006  
Page 2 of 2

Preston & Marilyn Pieper  
200 High Chaparral Loop  
Prescott, AZ 86303

PHOENIX, AZ 85004  
02 AUG 2012 PM 3:14



BLM  
ARIZONA STATE OFFICE  
ONE NORTH CENTRAL AVENUE SUITE 800  
PHOENIX, AZ 85004-4427

RECEIVED  
BLM AZ STATE OFFICE  
2012 AUG - 3 P 3:14  
PHOENIX, ARIZONA

85004442700



Preston & Marilyn Pieper  
200 High Chaparral Loop  
Prescott, AZ 86303

PHOENIX AZ 85004



BLM  
ARIZONA STATE OFFICE  
ONE NORTH CENTRAL AVENUE SUITE 800  
PHOENIX, AZ 85004-4427

RECEIVED  
BLM AZ STATE OFFICE  
2012 AUG -3 P 3:14  
PHOENIX, ARIZONA

85004442700



Preston & Marilyn Pieper  
200 High Chaparral Loop  
Prescott, AZ 86303

PHOENIX AZ 850  
02 AUG 2012 PM 3:14



BLM  
ARIZONA STATE OFFICE  
ONE NORTH CENTRAL AVENUE SUITE 800  
PHOENIX, AZ 85004-4427

RECEIVED  
BLM AZ STATE OFFICE  
2012 AUG - 3 P 3:14  
PHOENIX, ARIZONA

85004442700





**United States Department of the Interior**  
**Bureau of Land Management**  
LANDS/RECREATION & PLANNING  
ONE N CENTRAL AVE  
PHOENIX, AZ 85004 -2203  
Phone: 602-417-9200

Receipt

No: 2623745

Transaction #: 2704136

Date of Transaction: 08/06/2012

CUSTOMER:

PRESTON PIEPER  
200 HIGH CHAPARRAL  
PRESCOTT, AZ 86303-6356 US

LINE #	QTY	DESCRIPTION	REMARKS	UNIT PRICE	TOTAL
1	1.00	LOCATABLE MINERALS / MINING CLAIMS- NOT NEW-UNADJUD, ONE AUTH NO. ONLY / MINING CLAIM MONEY RECEIVED CASES: AMC412575/\$40.00	MAINT FEE WAIVER (2) 2013 / NOI (2) 2013 / POL (2) 2012	- n/a -	40.00
<b>TOTAL:</b>					<b>\$40.00</b>

## PAYMENT INFORMATION

1	AMOUNT:	40.00	POSTMARKED:	N/A
	TYPE:	CHECK	RECEIVED:	08/03/2012
	CHECK NO:	2397		
	NAME:	PIEPER, PRESTON 200 HIGH CHAPARRAL PRESCOTT AZ 86303-6356 US		

## REMARKS

This receipt was generated by the automated BLM Collections and Billing System and is a paper representation of a portion of the official electronic record contained therein.

**NOTICE!!**

**These documents have been scanned!**

**Do not place un-scanned documents beneath this notice!**

**Do not remove this notice from this file!**

GPO Jacket No. 560-102  
Print Order 61540  
Rise Business Services, LLC  
Job=AZ15 5/15/2019



Box Number= AZ15053



Claim Begin-End: AMC412575-AMC412576

6 Location Notices-Amendments and Supporting Documents



AZ15053-2

AMC412566-AMC413285

# MINING CLAIM STATUS REPORT

DATA  
ENTERED

DEC 29 2011 PB

MTP Checked by DEC 29 2011 PB

GEO Checked by DEC 29 2011 PB

LEAD SERIAL NUMBER AMC 412575 thru AMC 412576

## # OF CLAIMS & TYPE

# \_\_\_\_\_ LODGE  
# 2 PLACER  
# \_\_\_\_\_ ASSOCIATION PLACER  
# \_\_\_\_\_ MILL SITE  
# \_\_\_\_\_ TUNNEL SITE

## CHARGES

Location Fee @ \$34 = \$ 68.00  
Processing Fee @ \$15 = \$ 30.00  
Maintenance Fee @ \$140 = \$ 280.00  
Overage ( + ) \$  
Shortage ( - ) \$  
Other Fees \$  
TOTAL \$ 378.00

## ARE THERE ENOUGH LOCATORS?

Yes [ ] No [ ]

## DOCUMENTS RECEIVED VIA -

Over-the-Counter [ ] Mail [X]

## TIMELY FILED?

Yes [X] No [ ]

LEGAL DESCRIPTION - T 10N R 2E SEC 31, 32  
T \_\_\_\_\_ R \_\_\_\_\_ SEC \_\_\_\_\_  
T \_\_\_\_\_ R \_\_\_\_\_ SEC \_\_\_\_\_  
T \_\_\_\_\_ R \_\_\_\_\_ SEC \_\_\_\_\_

BLM [ ] FOREST SERVICE [ ] SUBJ TO PL 359: Yes [ ] No [ ]

WILDERNESS AREA: No [ ] Yes [ ]

SPLIT ESTATE - N/A [ ] SX [ ] PX [ ] SRHA [ ] OTHER [ ]

Proper Notice Filed if Located on SHRA Lands? N/A [ ] Yes [ ] No [ ]

## RECONVEYED MINERALS ON BLM LANDS REQUIRE OPENING ORDERS FROM 1944 TO 1993 -

Open to Entry on: \_\_\_\_\_ N/A [ ]

COMMENTS/STATUS - VOID [ ] PARTIALLY VOID [ ] PVT MINERALS [ ] WITHDRAWN LANDS [ ]

OTHER [ ]

Claimant acknowledges that portions of the following claims(s) site(s) may be void or voidable.

Printed Name of Claimant \_\_\_\_\_ Signature of Claimant \_\_\_\_\_

\*\*\*\*\* FINAL ADJUDICATION \*\*\*\*\*

DATE 7/30/2012 INITIALS RE

AMC412575

United States Department of the Interior  
Bureau of Land Management  
LANDS/RECREATION & PLANNING  
ONE N CENTRAL AVE  
PHOENIX, AZ 85004 -2203  
Phone: 602-417-9200

Receipt

No: 2653905

Transaction #: 2734762

Date of Transaction: 09/11/2012

CUSTOMER:

PRESTON PIEPER  
200 HIGH CHAPARRAL  
PRESCOTT, AZ 86303-6356 US

LINE #	QTY	DESCRIPTION	REMARKS	UNIT PRICE	TOTAL
1	1.00	LOCATABLE MINERALS / MINING CLAIMS-NOT NEW-UNADJUD, ONE AUTH NO. ONLY / MINING CLAIM MONEY RECEIVED CASES: AMC412575/\$20.00	AMENDMENT - 2	- n/a -	20.00
TOTAL:					\$20.00

PAYMENT INFORMATION					
1	AMOUNT:	20.00		POSTMARKED:	09/04/2012
	TYPE:	CHECK		RECEIVED:	09/11/2012
	CHECK NO:	2078			
	NAME:	RIDENHOUR, JAMES D 200 HIGH CHAPARRAL PRESCOTT AZ 86303-6356 US			

REMARKS

This receipt was generated by the automated BLM Collections and Billing System and is a paper representation of a portion of the official electronic record contained therein.

Amendments for AMC412575  
2 412576

ENTERED IN COMPUTER

R2 10.1.12

BLM Adjudication Dept  
Attention: Rod

8/3/2012

Rod,

Per our AM phone conversation on 8/3/2012, the following claims; AMC 412575 & AMC 412576 are **Gulch placer claims**.

An **amendment** will be made to the records you have on file and should be completed shortly.

Thank you,



Preston Pieper  
928-771-1782  
200 High Chaparral Prescott, AZ 86303

Attached are copies of the two notices I received on 8-2-2012

RECEIVED  
BLM AZ STATE OFFICE  
2012 AUG -6 P 2:54  
PHOENIX, ARIZONA



# **POOR QUALITY**

**The following pages are scanned at the best possible quality setting. The original pages are of poor quality and this is the best possible reproduction.**

# "Gulch claim"

## INFORMATION REGARDING LOCATING PLACER MINING CLAIMS

We have received your location notice(s) for placer mining claims. We are sending this information regarding the following claim(s): AMC 412575

The claim(s) is/are not located by aliquot parts using the rectangular survey system.

In accordance with 43 CFR 3832.12(c)(1) Unless the claims are on unsurveyed Federal land, are gulch or bench placer claims, or are bounded by other mining claims or nonmineral lands, the claim(s) should be described by aliquot parts using the rectangular survey system.

✓ The dimensions are incorrect. 2640' x 660'

Using the rectangular survey system the following are examples of correct dimensions for a placer claim: 20 acre claim = 1320 x 660; 40 acre claim = 1320 x 1320; 60 acres claim = 1980 x 1320; 80 acre claim = 2640 x 1320; 160 acre claim = 2640 x 2640

Small aliquot parts are: 10 acres = 660 x 660, or 1320 x 330; 5 acres = 660 x 330; 2.5 acres = 330 x 330

       The claim is located diagonally or in an odd or unusual shape.

A placer claim should not be located in this manner unless it is a gulch or bench placer claim or it is bounded by other mining claims or nonmineral lands. If the claim does fall into one of the categories mentioned, then it should be described using a protracted survey or by metes and bounds.

In accordance with 43 CFR 3832.12 (a) (1) For all claims and sites, you must describe the land by state, meridian, township, range, section and by aliquot part to the quarter section. In all cases, your description of the land must be as compact and regular in form as reasonably possible and should conform to the U.S. Public Land Survey System and its rectangular subdivisions as much as possible.

For placer claims, in accordance with 43 CFR 3832.12(c) (1) You must describe placer claims by aliquot part and complete lots using the U.S. Public Land Survey System and its rectangular subdivisions except when placer claims are -

(i) on unsurveyed Federal lands; (ii) Gulch or bench placer claims; or (iii) Bounded by other mining claims or nonmineral lands

(2) For placer mining claims that are on unsurveyed Federal lands or are gulch or bench placer claims: (i) You must describe the lands by protracted survey if the BLM has a protracted survey of record; or (ii) You may describe the lands by metes and bounds, if a protracted survey is not available or if the land is not amenable to protraction.

If after reading this information, you determine that the claim(s) are located incorrectly, in order to protect your interests, you should amend the claim(s). Please be aware that when amending a claim, you cannot take in any new ground. This may result in a claim that contains significantly less acreage than originally located. If you wish to retain the same acreage, you may want to relocate the claim correctly, rather than amend this claim.

Received 8-27-2

RECEIVED  
BLM AZ STATE OFFICE  
2007 AUG -9 P 254  
PHOENIX ARIZONA



"GULCH CLAIM"

INFORMATION REGARDING LOCATING PLACER MINING CLAIMS

We have received your location notice(s) for placer mining claims. We are sending this information regarding the following claim(s): AMC 412576

The claim(s) is/are not located by aliquot parts using the rectangular survey system.

In accordance with 43 CFR 3832.12(c)(1) Unless the claims are on unsurveyed Federal land, are gulch or bench placer claims, or are bounded by other mining claims or nonmineral lands, the claim(s) should be described by aliquot parts using the rectangular survey system

✓ The dimensions are incorrect. 1740' x 660'

Using the rectangular survey system the following are examples of correct dimensions for a placer claim: 20 acre claim = 1320 x 660; 40 acre claim = 1320 x 1320; 60 acres claim = 1980 x 1320; 80 acre claim = 2640 x 1320; 160 acre claim = 2640 x 2640

Small aliquot parts are: 10 acres = 660 x 660, or 1320 x 330; 5 acres = 660 x 330; 2.5 acres = 330 x 330

\_\_\_\_\_ The claim is located diagonally or in an odd or unusual shape.

A placer claim should not be located in this manner unless it is a gulch or bench placer claim or it is bounded by other mining claims or nonmineral lands. If the claim does fall into one of the categories mentioned, then it should be described using a protracted survey or by metes and bounds.

In accordance with 43 CFR 3832.12 (a) (1) For all claims and sites, you must describe the land by state, meridian, township, range, section and by aliquot part to the quarter section. In all cases, your description of the land must be as compact and regular in form as reasonably possible and should conform to the U.S. Public Land Survey System and its rectangular subdivisions as much as possible.

For placer claims, in accordance with 43 CFR 3832.12(c) (1) You must describe placer claims by aliquot part and complete lots using the U.S. Public Land Survey System and its rectangular subdivisions except when placer claims are -

(i) on unsurveyed Federal lands; (ii) Gulch or bench placer claims; or (iii) Bounded by other mining claims or nonmineral lands

(2) For placer mining claims that are on unsurveyed Federal lands or are gulch or bench placer claims: (i) You must describe the lands by protracted survey if the BLM has a protracted survey of record; or (ii) You may describe the lands by metes and bounds, if a protracted survey is not available or if the land is not amenable to protraction.

If after reading this information, you determine that the claim(s) are located incorrectly, in order to protect your interests, you should amend the claim(s). Please be aware that when amending a claim, you cannot take in any new ground. This may result in a claim that contains significantly less acreage than originally located. If you wish to retain the same acreage, you may want to relocate the claim correctly, rather than amend this claim.

RECEIVED  
BLM STATE OFFICE  
2012 JUN -6 P 2:54  
PHOENIX ARIZONA

Received 6-2-12

## INFORMATION REGARDING LOCATING PLACER MINING CLAIMS

We have received your location notice(s) for placer mining claims. We are sending this information regarding the following claim(s): AMC 412576

**The claim(s) is/are not located by aliquot parts using the rectangular survey system.**

In accordance with 43 CFR 3832.12(c)(1) Unless the claims are on unsurveyed Federal land, are gulch or bench placer claims, or are bounded by other mining claims or nonmineral lands, the claim(s) should be described by aliquot parts using the rectangular survey system

✓ The dimensions are incorrect. 1740' x 660'

Using the rectangular survey system the following are examples of correct dimensions for a placer claim: 20 acre claim = 1320 x 660; 40 acre claim = 1320 x 1320; 60 acres claim = 1980 x 1320; 80 acre claim = 2640 x 1320; 160 acre claim = 2640 x 2640

Small aliquot parts are: 10 acres = 660 x 660, or 1320 x 330; 5 acres = 660 x 330; 2.5 acres = 330 x 330

\_\_\_\_\_ The claim is located diagonally or in an odd or unusual shape.

A placer claim should not be located in this manner unless it is a gulch or bench placer claim or it is bounded by other mining claims or nonmineral lands. If the claim does fall into one of the categories mentioned, then it should be described using a protracted survey or by metes and bounds.

In accordance with 43 CFR 3832.12 (a) (1) For all claims and sites, you must describe the land by state, meridian, township, range, section and by aliquot part to the quarter section. In all cases, your description of the land must be as compact and regular in form as reasonably possible and should conform to the U.S. Public Land Survey System and its rectangular subdivisions as much as possible.

For placer claims, in accordance with 43 CFR 3832.12(c) (1) You must describe placer claims by aliquot part and complete lots using the U.S. Public Land Survey System and its rectangular subdivisions except when placer claims are –

(i) on unsurveyed Federal lands; (ii) Gulch or bench placer claims; or (iii) Bounded by other mining claims or nonmineral lands

(2) For placer mining claims that are on unsurveyed Federal lands or are gulch or bench placer claims: (i) You must describe the lands by protracted survey if the BLM has a protracted survey of record; or (ii) You may describe the lands by metes and bounds, if a protracted survey is not available or if the land is not amenable to protraction.

**If after reading this information, you determine that the claim(s) are located incorrectly, in order to protect your interests, you should amend the claim(s). Please be aware that when amending a claim, you cannot take in any new ground. This may result in a claim that contains significantly less acreage than originally located. If you wish to retain the same acreage, you may want to relocate the claim correctly, rather than amend this claim.**

Sent August 1, 2012  
R. Elmer



## INFORMATION REGARDING LOCATING PLACER MINING CLAIMS

We have received your location notice(s) for placer mining claims. We are sending this information regarding the following claim(s): AMC 412575

**The claim(s) is/are not located by aliquot parts using the rectangular survey system.**

In accordance with 43 CFR 3832.12(c)(1) Unless the claims are on unsurveyed Federal land, are gulch or bench placer claims, or are bounded by other mining claims or nonmineral lands, the claim(s) should be described by aliquot parts using the rectangular survey system

✓ The dimensions are incorrect. 2640' x 660'

Using the rectangular survey system the following are examples of correct dimensions for a placer claim: 20 acre claim = 1320 x 660; 40 acre claim = 1320 x 1320; 60 acres claim = 1980 x 1320; 80 acre claim = 2640 x 1320; 160 acre claim = 2640 x 2640

Small aliquot parts are: 10 acres = 660 x 660, or 1320 x 330; 5 acres = 660 x 330; 2.5 acres = 330 x 330

\_\_\_\_\_ The claim is located diagonally or in an odd or unusual shape.

A placer claim should not be located in this manner unless it is a gulch or bench placer claim or it is bounded by other mining claims or nonmineral lands. If the claim does fall into one of the categories mentioned, then it should be described using a protracted survey or by metes and bounds.

In accordance with 43 CFR 3832.12 (a) (1) For all claims and sites, you must describe the land by state, meridian, township, range, section and by aliquot part to the quarter section. In all cases, your description of the land must be as compact and regular in form as reasonably possible and should conform to the U.S. Public Land Survey System and its rectangular subdivisions as much as possible.

For placer claims, in accordance with 43 CFR 3832.12(c) (1) You must describe placer claims by aliquot part and complete lots using the U.S. Public Land Survey System and its rectangular subdivisions except when placer claims are –

(i) on unsurveyed Federal lands; (ii) Gulch or bench placer claims; or (iii) Bounded by other mining claims or nonmineral lands

(2) For placer mining claims that are on unsurveyed Federal lands or are gulch or bench placer claims: (i) You must describe the lands by protracted survey if the BLM has a protracted survey of record; or (ii) You may describe the lands by metes and bounds, if a protracted survey is not available or if the land is not amenable to protraction.

**If after reading this information, you determine that the claim(s) are located incorrectly, in order to protect your interests, you should amend the claim(s). Please be aware that when amending a claim, you cannot take in any new ground. This may result in a claim that contains significantly less acreage than originally located. If you wish to retain the same acreage, you may want to relocate the claim correctly, rather than amend this claim.**

Sent August 1, 2012  
R Elen



When Recorded Return Document to:

PRESTON PIEPER  
200 HIGH CHAPARRAL  
PRESCOTT, AZ 86303

B: 4903 P: 344 09/04/2012 09:26:40 AM ANML  
Leslie M. Hoffman  
OFFICIAL RECORDS AVAPAI COUNTY \$10.00  
PRESTON PIEPER 0049556

B: 4903 P: 344 09/04/2012 09:26:40 AM ANML  
\$10.00 Page: 1 of 2 2012-0049556  
[Barcode]

"ADMENDMENT"  
BOOK 4843 PAGE 857

AMC 412575

Amc 412575

LOCATION NOTICE FOR PLACER MINING CLAIM

NOTICE IS HEREBY GIVEN that the MPCD 1

\_\_\_\_\_ placer mining claim has been located by

PRESTON PIEPER / MARILYN PIEPER whose current mailing

address is 200 HIGH CHAPARRAL

PRESCOTT, AZ 86303

BLM  
Date  
Stamp

RECEIVED  
AZ STATE OFFICE  
2012 SEP 10 P 2:37  
PHOENIX, ARIZONA

The general course of this claim is NORTH TO SOUTH and it is situated in

YAVAPAI County, Arizona.

This claim is 1320 feet in length and 660 feet in width. This claim runs from the location monument on which this location notice is posted approximately 3 feet in a SOUTH direction to the SOUTH end line and 1317 feet in a NORTH direction to the NORTH end line. This claim is marked by four monuments, one at each corner of the claim.

The location monument on which this notice is posted is situated within Section 31, Township T 10 N, Range R 2 E, Gila Salt River Base and Meridian, Arizona. This claim encompasses portions of the following legal subdivision(s) if located by legal subdivision or the following quarter section(s), section(s), Township(s) and Range(s) SE 1/4 AND NE 1/4, SECTION 31, T 10 N, R 2 E, Gila Salt River Base and Meridian, Arizona.

The locality of this claim with reference to some natural object or permanent monument and additional information (if any) concerning its locality are as follows: THE SOUTH EAST CORNER IS ABOUT 3/4 MILE IN A SOUTH EAST DIRECTION TO THE JUNCTION OF BLACK CANYON AND BUMBLE BEE CREEKS.

DATED AND POSTED on the ground this 15 day of NOVEMBER, 2011.

LOCATOR(s) P. Pieper / Marilyn Pieper  
PRESTON PIEPER / MARILYN PIEPER

Form MCF102  
Revised July 2005

This form is available from the Arizona Department of Mines & Mineral Resources and may be reproduced.

ENTERED IN COMPUTER  
R2 10.1.12

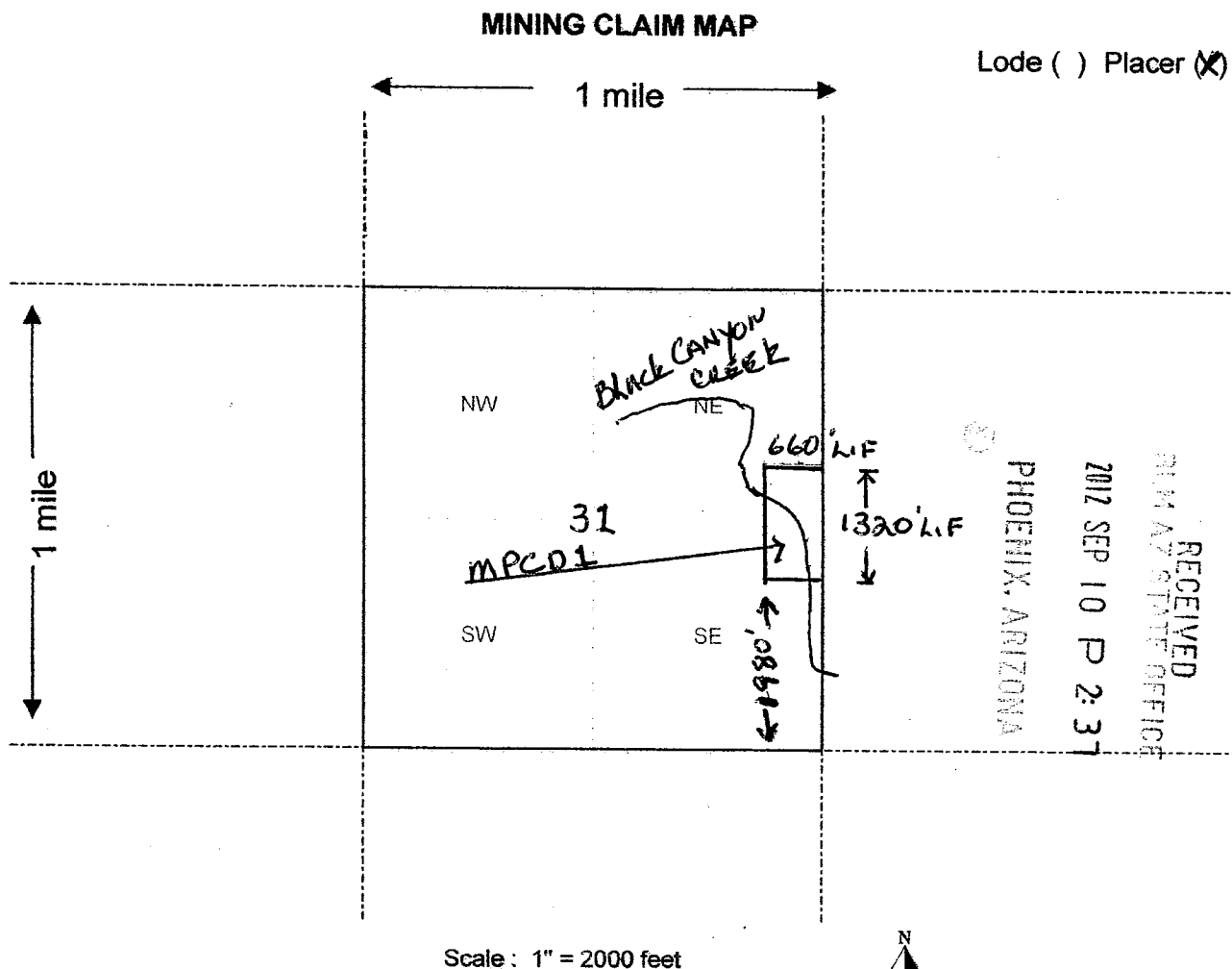

- The above map depicts the MPCD 1 mining claim, which is located in Section (s) 31, Township 10 N, Range 2 E, Gila and Salt River Base and Meridian, YAVAPAI County, Arizona.
- The type of corner and location monuments used are as follows: STEEL POST AND PLASTIC PIPE
- The bearings and distances in degrees and feet between claim corners are as depicted on the map.

Form MCF100a  
Revised July 2005

This form is available from the Arizona Department of Mines & Mineral Resources and may be reproduced.

When recorded, mail to:

Name: PRESTON PIEPER

Address: 200 HIGH CHAPARRAL

City/State/Zip Code: PRESCOTT, AZ 86303

B: 4843 P: 857 11/07/2011 09:43:51 AM NML  
\$14.00 Page: 1 of 2 2011-0057913

Space above this line for Recorder's use

## NOTICE OF MINING CLAIM

1. TYPE OF NOTICE: ☐ Location ☐ Amendment ☒ Relocation
2. TYPE OF CLAIM: ☒ Placer ☐ Lode ☐ Millsite ☐ Tunnelsite
3. The name and address of the Locator is  
Name: PRESTON PIEPER / MARILYN PIEPER  
Address: 200 HIGH CHAPARRAL  
City/State/Zip Code: PRESCOTT / AZ / 86303
4. The name of the claim is MPCDL
5. The date of the location is 11-5-2011
6. The claim is 2640 feet long and 660 feet wide. The distance from the location monument to each end of the claim is 3 feet in a SOUTH direction and 2637 feet in a NORTH direction.
7. The general course of the claim is from the SOUTH to the NORTH
8. The location of the claim is in Section 31, Township 10 NORTH, Range 2 EAST, GILA AND SALT RIVER Base and Meridian, Mining District, YAVAPAI County, State of ARIZONA
9. If amending or relocating, the previous claim name was MPCDL AMC 406986 recorded in Docket(Book) 4800 page(s) 929 Mining District, YAVAPAI County, State of ARIZONA
10. The location of the claim with reference to a natural object or permanent monument is THE SOUTH EAST CORNER IS ABOUT 3/4 MILE SOUTH EAST TO THE JUNCTION OF BLACK CANYON AND BOMBIE BEE CREEKS

Dated: 11-5-2011

\* PRESTON PIEPER  
MARILYN PIEPER

P. Pieper Signature  
200 HIGH CHAPARRAL Address  
PRESCOTT / AZ / 86303 City/State/Zip

AMC 412575

# MAP OF MINING CLAIM LOCATION

1. The name of the claim is MPCDL
2. The SOUTH EAST corner of the claim is ABOUT 3960 feet in a SOUTH EAST direction to a survey monument or permanent natural object described as THE JUNCTION OF BLACK CANYON AND BUMBLE BEE CREEKS
3. The type of location monument is STEEL POST AND PVC PIPE  
The type of corner end monuments are STEEL POST AND PVC PIPE
4. The bearing and distance between the corners of the claim are beginning at the SOUTH EAST corner of the claim, 660 feet in a WESTERLY direction to the SOUTH WEST corner, then 2640 feet in a NORTHERLY direction to the NORTH WEST corner, then 660 feet in a EASTERLY direction to the NORTH EAST corner, then 2640 feet in a SOUTHERLY direction to the point of beginning.

RECORDERS MEMO: LEGIBILITY  
QUESTIONABLE FOR GOOD REPRODUCTION

## MAP

North Arrow



One inch = One thousand feet

ONE MILE

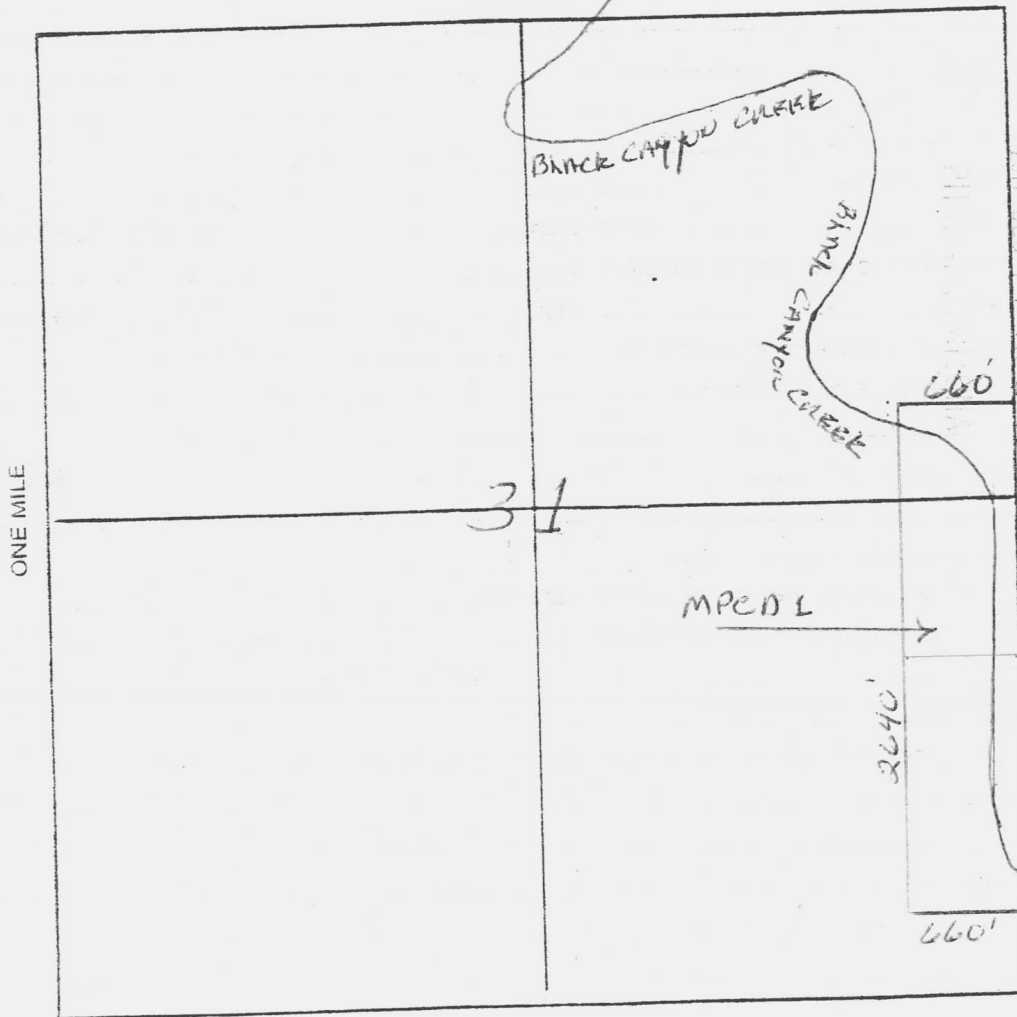

RECEIVED  
BLM AZ STATE OFFICE  
2011 DEC 14 PM 2:05  
640 ACRES

Section 31 Range 2 EAST Township 10 NORTH  
GILA AND SALT RIVER Base and Meridian.  
Dated: 11-5-2011 Signature [Signature]



When Recorded Return Document to:

PRESTON PIEPER  
200 HIGH CHAPARRAL  
PRESCOTT, AZ 86303

B: 4903 P: 345 09/04/2012 09:26:40 AM ANML  
Leslie M. Hoffn  
OFFICIAL RECORD YAVAPAI COUNTY \$10.00  
PRESTON PIEPER 2012-0049557

B: 4903 P: 345 09/04/2012 09:26:40 AM ANML  
\$10.00 Page: 1 of 2 2012-0049557

"ADMENDMENT"  
BOOK 4843 PAGE 856

AMC 412576

LOCATION NOTICE FOR PLACER MINING CLAIM

NOTICE IS HEREBY GIVEN that the MPCD 2

PRESTON PIEPER / MARILYN PIEPER placer mining claim has been located by  
whose current mailing  
address is 200 HIGH CHAPARRAL  
PRESCOTT, AZ 86303

BLM  
Date  
Stamp

RECEIVED  
BLM AZ STATE OFFICE  
2012 SEP 10 P 2:37  
PHOENIX, ARIZONA

The general course of this claim is WEST TO EAST and it is situated in  
YAVAPAI County, Arizona.

This claim is 1320 feet in length and 660 feet in width. This claim runs from the  
location monument on which this location notice is posted approximately 3 feet in a EAST  
direction to the EAST end line and 1317 feet in a WEST direction to the WEST end line.  
This claim is marked by four monuments, one at each corner of the claim.

The location monument on which this notice is posted is situated within Section 32, Township  
10 N, Range 2 E, Gila Salt River Base and Meridian, Arizona. This claim encompasses  
portions of the following legal subdivision(s) if located by legal subdivision or the following quarter section (s),  
section (s), Township (s) and Range (s) SW 1/4, SECTION 32, T 10 N,  
R 2 E, Gila Salt River Base and Meridian, Arizona.

The locality of this claim with reference to some natural object or permanent monument and additional  
information (if any) concerning its locality are as follows: THE SOUTH EAST CORNER  
IS ABOUT 5/8 MILE IN A SOUTH EAST DIRECTION TO  
THE JUNCTION OF BLACK CANYON AND BUMBLE BEE CREEKS

DATED AND POSTED on the ground this 5 day of NOVEMBER, 20 11.

LOCATOR (s) Preston Pieper / Marilyn Pieper

PRESTON PIEPER / MARILYN PIEPER

Form MCF102  
Revised July 2005

This form is available from the Arizona Department of Mines & Mineral Resources and may be reproduced.

ENTERED IN COMPUTER  
R2 10/11/12



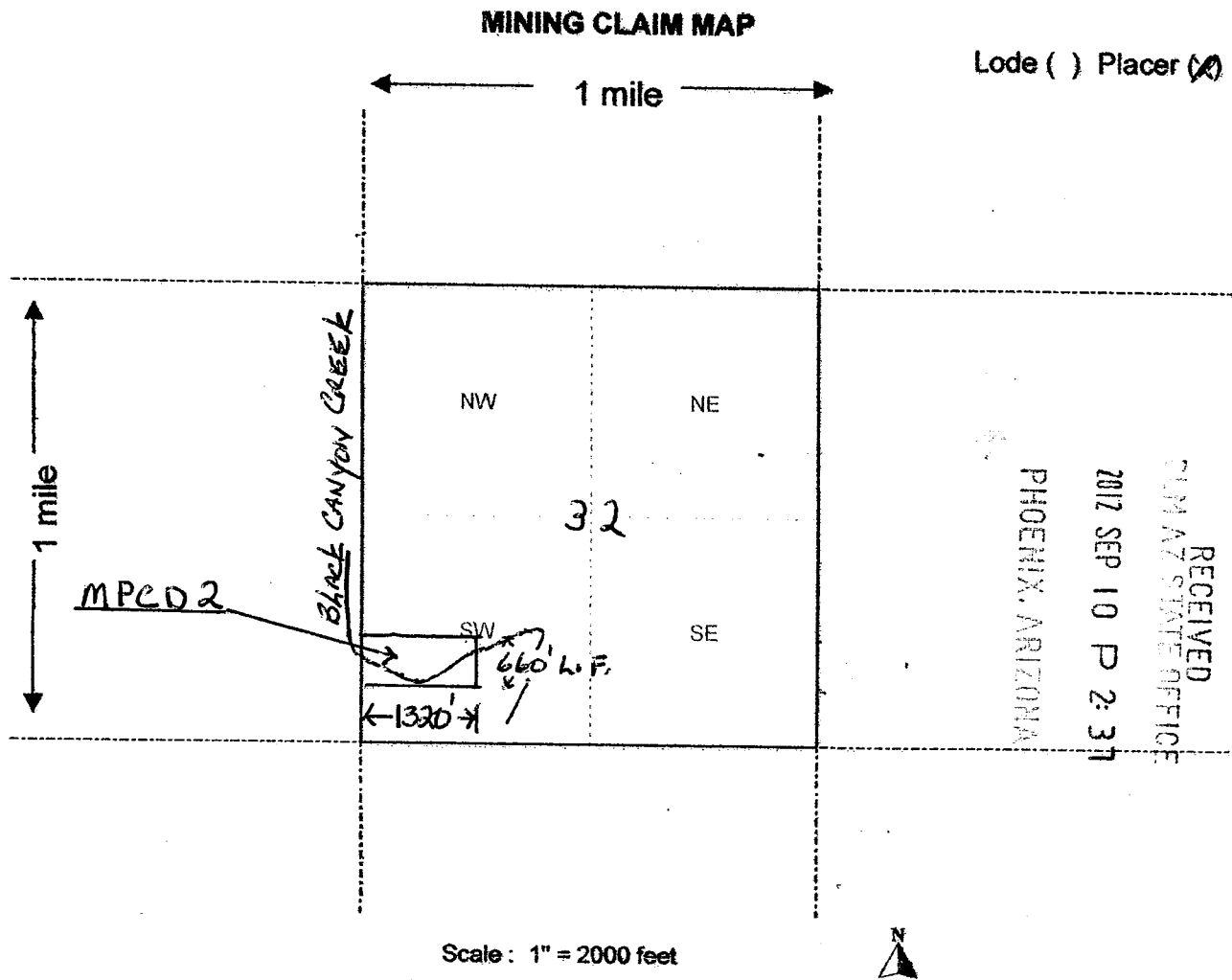

1. The above map depicts the MPCD 2 mining claim, which is located in Section (s) 32, Township 10 N, Range 2 E, Gila and Salt River Base and Meridian, YAVAPAI County, Arizona.
2. The type of corner and location monuments used are as follows: STEEL POST AND PLASTIC PIPE
3. The bearings and distances in degrees and feet between claim corners are as depicted on the map.

Form MCF100a  
Revised July 2005

This form is available from the Arizona Department of Mines & Mineral Resources and may be reproduced.

When recorded, mail to:

Name: PRESTON PIEPER

Address: 200 HIGH CHAPARRAL

City/State/Zip Code: PRESCOTT, AZ 86303

B: 4843 P: 856  
Ana Wayman-Trujillo  
OFFICIAL RECORDS OF YAVAPAI COUNTY \$14.00  
PRESTON PIEPER 2011-0057912

11/07/2011 09:43:51 AM

NML

B: 4843 P: 856  
\$14.00

Page: 1 of 2

11/07/2011 09:43:51 AM

NML

Space above this line for Recorder's use

## NOTICE OF MINING CLAIM

1. TYPE OF NOTICE: ☐ Location ☐ Amendment ☒ Relocation  
2. TYPE OF CLAIM: ☒ Placer ☐ Lode ☐ Millsite ☐ Tunnelsite

3. The name and address of the Locator is

Name: PRESTON PIEPER / MARILYN PIEPER

Address: 200 HIGH CHAPARRAL

City/State/Zip Code: PRESCOTT, AZ / 86303

4. The name of the claim is MPC02

5. The date of the location is 11-5-2011

6. The claim is ABOUT 1740' feet long and 660 feet wide. The distance from the location monument to each end of the claim is 3 feet in a EAST direction and ABOUT 1737 feet in a WEST direction.

7. The general course of the claim is from the EAST to the WEST

8. The location of the claim is in Section 32, Township 10 NORTH, Range 2 EAST

GILA AND SALT RIVER Base and Meridian,  
Mining District, YAVAPAI County,  
State of ARIZONA

9. If amending or relocating, the previous claim name was MPC03 AMC 406987  
recorded in Docket(Book) 4800 page(s) 928

Mining District, YAVAPAI County,  
State of ARIZONA

10. The location of the claim with reference to a natural object or permanent monument is THE  
SOUTHEAST CORNER OF THE CLAIM IS ABOUT 5/8 MILE  
SOUTH EAST DIRECTION TO THE JUNCTION OF BLACK CANYON  
AND BUMBLE BEE CREEKS

Dated: 11-5-2011

X PRESTON PIEPER  
MARILYN PIEPER

Preston Pieper  
Signature  
200 HIGH CHAPARRAL  
Address  
PRESCOTT, AZ / 86303  
City/State/Zip

AMC 412576

# MAP OF MINING CLAIM LOCATION

1. The name of the claim is MPCD2
2. The SOUTHEAST corner of the claim is ABOUT 3160 feet in a SOUTHEAST direction to a survey monument or permanent natural object described as THE JUNCTION OF BLACK CANYON AND BUMBLE BEE CREEKS
3. The type of location monument is STEEL POST AND PVC PIPE  
The type of corner end monuments are STEEL POST AND PVC PIPE
4. The bearing and distance between the corners of the claim are beginning at the SOUTHEAST corner of the claim, ABOUT 1740 feet in a WESTERLY direction to the SOUTHWEST corner, then 660 feet in a NORTHERLY direction to the NORTHWEST corner, then ABOUT 1740 feet in a EASTERLY direction to the NORTHEAST corner, then 660 feet in a SOUTHERLY direction to the point of beginning.

RECORDERS MEMO: LEGIBILITY  
QUESTIONABLE FOR GOOD REPRODUCTION

## MAP

North Arrow



ONE MILE

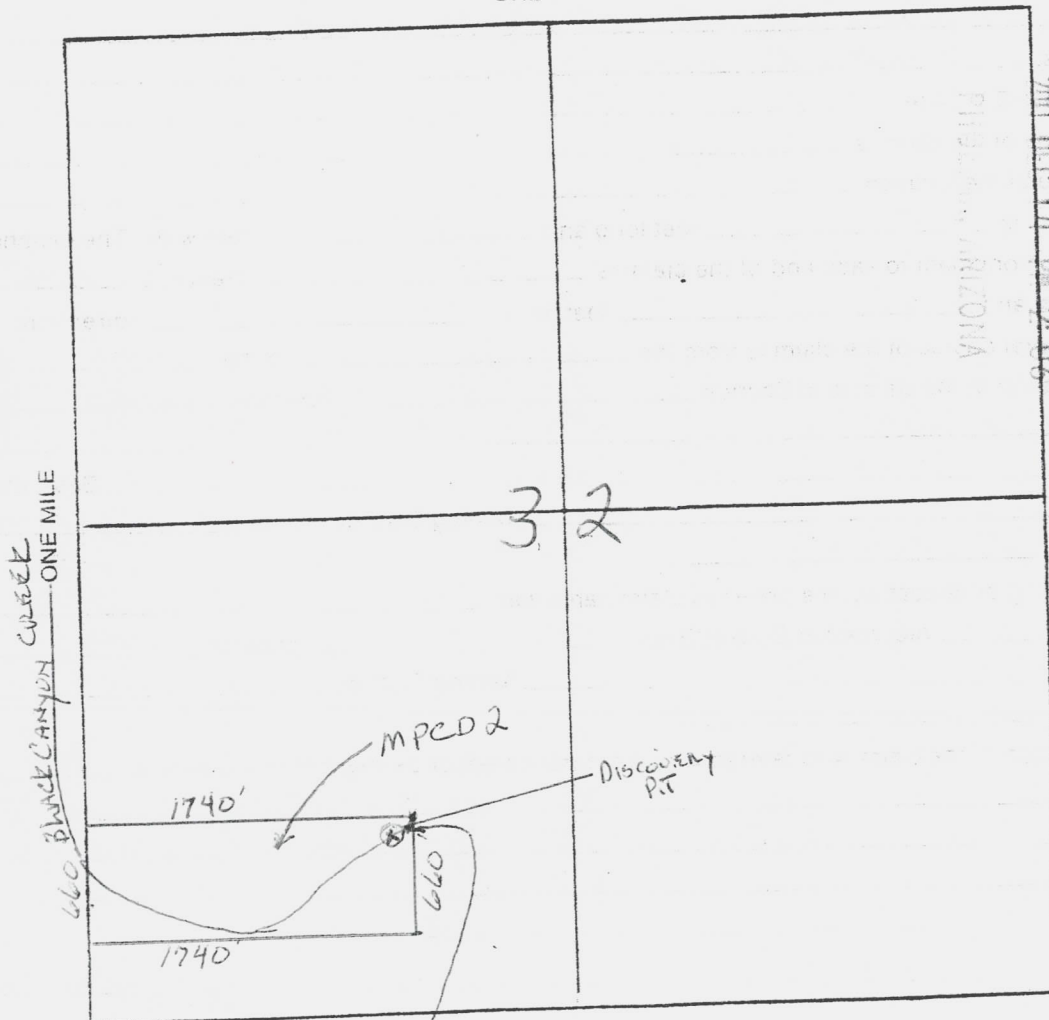

Section 32 Range 2E Township 10N  
GILA AND SALT RIVER Base and Meridian.  
Dated: 11-5-2011 Signature [Signature]

RUN TIME: 10:13 AM

DEPARTMENT OF INTERIOR  
BUREAU OF LAND MANAGEMENT

RUN DATE: 12/29/2011  
Page 1 of 1

Input Parameters for Geographic Report with Land

System Id = CR

Admin State = AZ

Geo State = AZ

Casetype Begins With

Case Disp Txt = AUTHORIZED, CANCELLED, EXPIRED, PENDING, REJECTED, RELINQUISHED, WITHDRAWN

Mer Twp Rng =

Section =

Mtrs = 14 0100N 0020E 031, 14 0100N 0020E 032, 14 0100N 0020E 999

Commodity =

Commodity Txt =

Pending Org =

Pend Org Decode =

Total Rows Returned: 21

NO WARRANTY IS MADE BY BLM FOR USE OF THE DATA  
FOR PURPOSES NOT INTENDED BY BLM

RUN TIME: 10:13 AM

Adm State: AZ

UNITED STATES DEPARTMENT OF INTERIOR  
BUREAU OF LAND MANAGEMENT  
GEOGRAPHIC REPORT WITH LAND  
Sorted by Meridian Township Range

RUN DATE: 12/29/2011  
Page 1 of 3

Serial Number: AZA 002936  
Total Case Acres: 65,501.000

<u>Casetype</u>	<u>Case Disp</u>	14	0100N	0020E	<u>Sect</u>	<u>Sur Typ</u>	<u>Sur Num</u>	<u>Suff</u>	<u>Subdivision</u>	<u>Act Pend</u>
246100	AUTHORIZED				031	ALIQ			E2NE,SE;	
					032	LOTS			1,6;	
						ALIQ			ALL;	

Serial Number: AZA 022689  
Total Case Acres: 2,161.980

<u>Casetype</u>	<u>Case Disp</u>	14	0100N	0020E	<u>Sect</u>	<u>Sur Typ</u>	<u>Sur Num</u>	<u>Suff</u>	<u>Subdivision</u>	<u>Act Pend</u>
206400	AUTHORIZED				031	ALIQ			W2SENE,SWNESW,E2W2SESW;	
						ALIQ	1		W2SESESW,E2E2NWSE;	
						ALIQ	2		E2NESWSE,W2NWSESE;	
						ALIQ	3		SENWSESE,N2SWSESE;	
						ALIQ	4		SESWSESE;	
						FF	1		PTS OF LOTS 1, 6-9;	

Serial Number: AZA 022699PT  
Total Case Acres: 12,382.940

<u>Casetype</u>	<u>Case Disp</u>	14	0100N	0020E	<u>Sect</u>	<u>Sur Typ</u>	<u>Sur Num</u>	<u>Suff</u>	<u>Subdivision</u>	<u>Act Pend</u>
221006	AUTHORIZED				031	ALIQ			E2SW;	
						LOTS			3-5,7-10;	

Serial Number: AZA 028093  
Total Case Acres: 1.000

<u>Casetype</u>	<u>Case Disp</u>	14	0100N	0020E	<u>Sect</u>	<u>Sur Typ</u>	<u>Sur Num</u>	<u>Suff</u>	<u>Subdivision</u>	<u>Act Pend</u>
380913	EXPIRED				032	FF		1	PORTION OF;	



RUN TIME: 10:13 AM

Adm State: AZ

UNITED STATES DEPARTMENT OF INTERIOR  
BUREAU OF LAND MANAGEMENT  
GEOGRAPHIC REPORT WITH LAND  
Sorted by Meridian Township Range

RUN DATE: 12/29/2011  
Page 2 of 3

Serial Number: AZA 029793

Total Case Acres: 3.000

<u>Casetype</u>	<u>Case Disp</u>				<u>Sect</u>	<u>Sur Typ</u>	<u>Sur Num</u>	<u>Suff</u>	<u>Subdivision</u>	<u>Act Pend</u>
380913	AUTHORIZED	14	0100N	0020E	031	ALIQ			N2NE;	

Serial Number: AZA 031851

Total Case Acres: 1.000

<u>Casetype</u>	<u>Case Disp</u>				<u>Sect</u>	<u>Sur Typ</u>	<u>Sur Num</u>	<u>Suff</u>	<u>Subdivision</u>	<u>Act Pend</u>
293200	AUTHORIZED	14	0100N	0020E	032	FF			PORTION OF;	

Serial Number: AZA 033348

Total Case Acres: 1.000

<u>Casetype</u>	<u>Case Disp</u>				<u>Sect</u>	<u>Sur Typ</u>	<u>Sur Num</u>	<u>Suff</u>	<u>Subdivision</u>	<u>Act Pend</u>
371511	AUTHORIZED	14	0100N	0020E	031	FF			NE;	

Serial Number: AZA 033433

Total Case Acres: 1.000

<u>Casetype</u>	<u>Case Disp</u>				<u>Sect</u>	<u>Sur Typ</u>	<u>Sur Num</u>	<u>Suff</u>	<u>Subdivision</u>	<u>Act Pend</u>
293200	EXPIRED	14	0100N	0020E	031	FF			PORTION OF;	
					032	FF			PORTION OF;	

Serial Number: AZA 033672

Total Case Acres: 1.000

<u>Casetype</u>	<u>Case Disp</u>				<u>Sect</u>	<u>Sur Typ</u>	<u>Sur Num</u>	<u>Suff</u>	<u>Subdivision</u>	<u>Act Pend</u>
293200	EXPIRED	14	0100N	0020E	032	FF			PORTION OF;	

RUN TIME: 10:14 AM

UNITED STATES DEPARTMENT OF INTERIOR  
BUREAU OF LAND MANAGEMENT  
GEOGRAPHIC REPORT WITH LAND  
Sorted by Meridian Township Range

RUN DATE: 12/29/2011  
Page 3 of 3

Serial Number: AZA 033821

Total Case Acres: 1.000

<u>Casetype</u>	<u>Case Disp</u>	14	0100N	0020E	<u>Sect</u>	<u>Sur Typ</u>	<u>Sur Num</u>	<u>Suff</u>	<u>Subdivision</u>	<u>Act Pend</u>
293200	AUTHORIZED				031	FF			PORTION OF;	

Serial Number: AZA 034418

Total Case Acres: 1.000

<u>Casetype</u>	<u>Case Disp</u>	14	0100N	0020E	<u>Sect</u>	<u>Sur Typ</u>	<u>Sur Num</u>	<u>Suff</u>	<u>Subdivision</u>	<u>Act Pend</u>
380913	AUTHORIZED				031	ALIQ			NE;	
					032	ALIQ			SW;	

YAVAPAI COUNTY  
HASSAYAMPA FIELD OFFICE

[illegible]

---

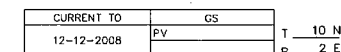

**WARNING STATEMENT**  
This plot is the Bureau's Record of Title, and should be used only as a graphic display of the township survey data. Records hereon do not reflect title changes which may have been affected by lateral movements of rivers or other bodies of water. Refer to the control survey for official survey information.